

# Cast steel/stainless steel ball valve

● Q41F ● Q341F ● Q641F ● Q941F

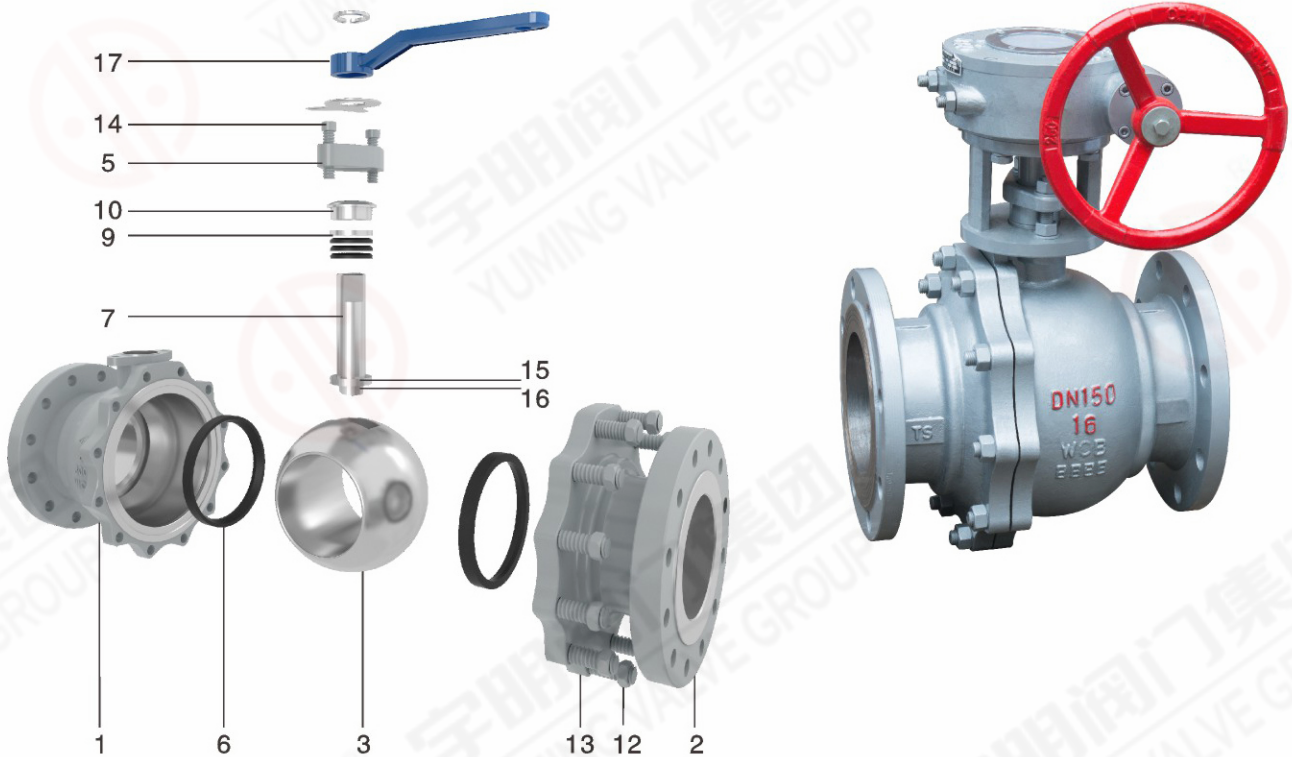

## Parts material

No.	Components	Carbon steel	Stainless steel	Low temperature
1	Body	ASTMA216-WCB	ASTMA315-CF8M	ASTMA352-LCB
2	Bonnet	ASTMA216-WCB	ASTMA315-CF8M	ASTMA352-LCB
3	Ball	201/304	ASTMA182-F316	ASTMA182-F316
4	Yoke	Carbon steel	Carbon steel	Carbon steel
5	Pressure plate	Carbon steel	ASTMA315-CF8M	ASTMA352-LCB
6	Seat	PTFE/EPDM	EPDM	EPDM
7	Stem	20Cr13	ASTMA182-F316	ASTMA182-F316
9	Gasket	EPDM	EPDM	316SS+Graphite
10	Packing group	EPDM	EPDM	Graphite
12	Nut	25	ASTMA194-8	ASTMA194-7M
13	Bolt	35	ASTMA193-B8	ASTMA193-L7M
14	Socket head cap screws	35	ASTMA193-B8	ASTMA193-L7M
15	Spring	Stainless steel	ASTMA193-B8	ASTMA193-L7M
16	Steel ball	Stainless steel	Stainless steel	Stainless steel
17	Handle	WCB	Stainless steel	Stainless steel

# Stainless steel ball valve

- Q41F-16/25C 精铸球阀
- Q41PPL-16/25C 高温球阀
- Q41F-40 液化气球阀
- Q341F-16C/25C
- Q341PPL-16C/25C

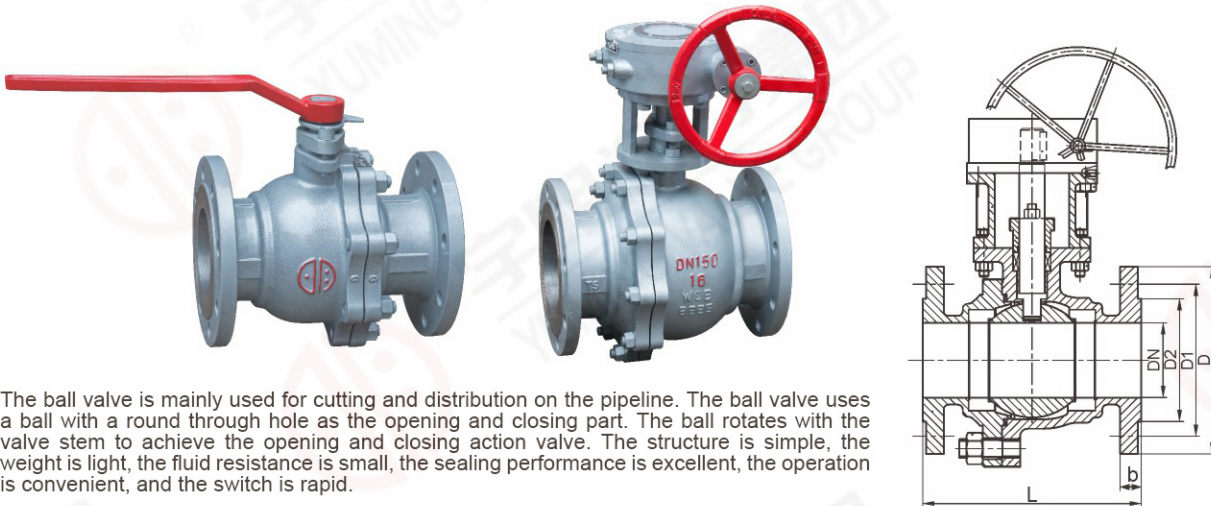

The ball valve is mainly used for cutting and distribution on the pipeline. The ball valve uses a ball with a round through hole as the opening and closing part. The ball rotates with the valve stem to achieve the opening and closing action valve. The structure is simple, the weight is light, the fluid resistance is small, the sealing performance is excellent, the operation is convenient, and the switch is rapid.

### Major performance specifications

Nominal pressure(MPa)	Test pressure(MPa)		Working temperature(°C)			Suitable medium
	Shell	Seal(air)	PPL	PackingF4	F4	
1.6	2.4	0.6	-29~300	-29~200	-29~150	water, steam, oil
2.5	3.75	0.6				
4.0	6.0	0.6	-40°C~150°C			Liquefied petroleum gas, liquid ammonia, etc.

### Parts material

Body/Bonnet	Stem	Ball	Seat
WCB	20Cr13	201/304	填充F4(黑)或F4(白) 或PPL高温密封圈

- RQ41F型燃气专用球阀
- RQ341F型燃气专用球阀

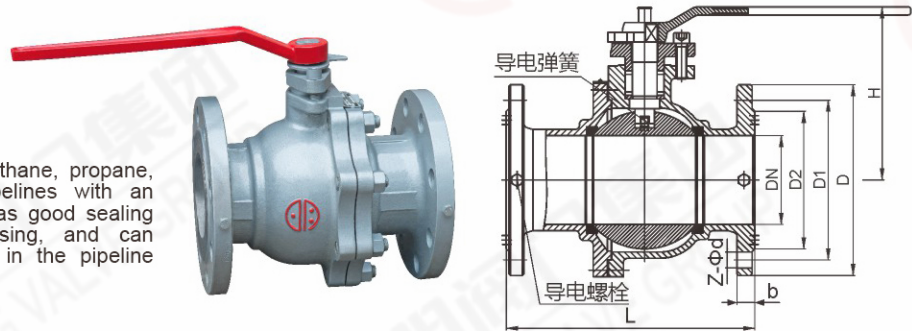

The valve is suitable for natural gas, methane, propane, ethane and other combustible gas pipelines with an operating temperature of -29~120°C. It has good sealing performance, flexible opening and closing, and can effectively eliminate the static electricity in the pipeline operation.

### Major performance specifications

Nominal pressure(MPa)	Test pressure(MPa)		Working temperature(°C)	Suitable medium
	Shell	Seal(air)		
1.6	2.4	0.6	-29~120	Natural gas, gas, etc.
2.5	3.75	0.6		

### Major performance specifications

Body/Bonnet	Stem	Ball	Seat
WCB	20Cr13	201/304	F4



# Cast steel ball valve

- Q41F-16/25C 精铸球阀
- Q41PPL-16/25C 高温球阀
- RQ41F-16/25C 燃气球阀
- Q41F-40 液化气球阀
- Q341F-16C/25C
- Q341PPL-16C/25C
- RQ341F-16/25C

## The main connection size and size

DN	L	D	D1	D2	b	Z-Φd	H	L0
PN16								
15	130	95	65	45	14	4-Φ14	78	140
20	140	105	75	55	14	4-Φ14	84	160
25	150	115	85	65	14	4-Φ14	95	180
32	165	135	100	78	16	4-Φ18	150	250
40	180	145	110	85	16	4-Φ18	150	300
50	203	160	125	100	16	4-Φ18	170	350
65	220	180	145	120	18	4-Φ18	195	350
80	250	195	160	135	20	8-Φ18	215	400
100	280	215	180	155	20	8-Φ18	250	500
125	325	245	210	185	22	8-Φ18	265	600
150	360	280	240	210	24	8-Φ23	270	800
200	400	335	295	265	24	12-Φ23	330	800
250	457	405	355	320	26	12-Φ25	450	1300

DN	L	D	D1	D2	b	Y	Z-Φd	H	L0
PN25									
15	130	95	65	45	16	-	4-Φ14	103	100
20	140	105	75	55	16	-	4-Φ14	112	160
25	150	115	85	65	16	-	4-Φ14	123	160
32	165	135	100	78	18	-	4-Φ18	150	250
40	180	145	110	85	18	-	4-Φ18	156	250
50	200	160	125	100	20	-	4-Φ18	172	350
65	220	180	145	120	22	-	8-Φ18	197	350
80	250	195	160	135	22	-	8-Φ18	222	450
100	280	230	190	160	24	-	8-Φ23	253	450
125	325	270	220	188	28	-	8-Φ25	275	600
150	360	300	250	218	30	-	8-Φ25	286	800
200	455	360	310	278	34	-	12-Φ25	340	1200
250	504	425	370	332	36	-	12-Φ30	470	1400

DN	L	D	D1	D2	b	Y	Z-Φd	H	L0
PN40									
15	130	95	65	45	16	40	4-Φ14	103	100
20	140	105	75	55	16	51	4-Φ14	112	160
25	150	115	85	65	16	58	4-Φ14	123	160
32	165	135	100	78	18	66	4-Φ18	150	250
40	180	145	110	85	18	76	4-Φ18	156	250
50	200	160	125	100	20	88	4-Φ18	172	350
65	220	180	145	120	22	110	8-Φ18	197	350
80	250	195	160	135	22	121	8-Φ18	222	450
100	280	230	190	160	24	150	8-Φ23	253	450
125	325	270	220	188	28	176	8-Φ25	275	600
150	360	300	250	218	30	204	8-Φ25	286	800
200	502	375	320	282	38	260	12-Φ30	340	1200
250	568	445	385	345	42	313	12-Φ34	470	1400

# Stainless steel ball valve

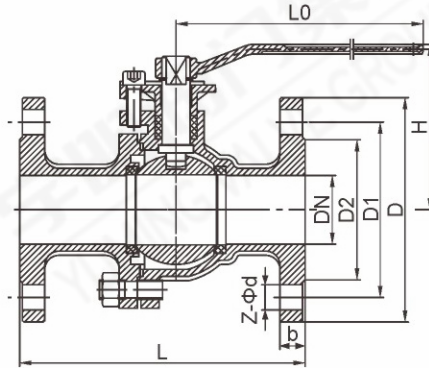

Q41F stainless steel ball valve is mainly used for places with high requirements for corrosive, stressful and sanitary environments. Stainless steel ball valve is a new type of valve widely used in recent years.

## Features

- 1.The fluid resistance is small, and its drag coefficient is equal to that of the same length.
- 2.Simple structure, small size and light weight.
- 3.It is tight and reliable. At present, the sealing surface material of the ball valve is widely used in plastics and has good sealing performance. It is also widely used in vacuum systems.
- 4.Easy to operate, open and close quickly, from full open to fully closed as long as the rotation of 90 °, easy remote control.
- 5.Easy maintenance, ball valve structure is simple, the seal ring is generally active, removal and replacement are more convenient.
- 6.When fully open or fully closed, the sealing surfaces of the ball valve and the valve seat are isolated from the medium. When the medium passes through, the sealing surface of the valve will not be eroded.
- 7.The scope of application, from small to several millimeters in diameter, up to a few meters, can be applied from vacuum to high pressure.

## Major performance specifications

product material		304系列	304L系列	316系列	316L系列	321系列
main parts	Body/Bonnet	CF8(304)	CF8(304L)	CF8(316)	CF3M(316L)	0Cr18Ni10Ti
	Ball/Stem	304	304L	316	316L	321
	Bolt	A193-B8	A193-B8	A193-B8	A193-B8	A193-B8
	Nut	A194-8M	A194-8M	A194-8M	A194-8M	A194-8M
	Seal ring	PTFE				
	Packing	PTFE				
Working conditions	Suitable medium	Nitric acid type media		Acetic acid type medium		
	proper temperature	≤200°C				
Application specification	Flange size connection	GB/T9113, HG/T20592, SH3406				
	Inspection test	GB/T26480, JB/T9092				
	Nominal pressure	1.0~10.0MPa				
Driving method		Manual, pneumatic, electric, hydraulic, etc.				



# Stainless steel ball valve

The main connection size

DN	L	D	D1	D2	b	Z-Φd	H	L0
PN16								
15	130	95	65	45	14	4-Φ14	78	140
20	130	105	75	55	14	4-Φ14	84	160
25	140	115	85	65	14	4-Φ14	95	180
32	165	135	100	78	16	4-Φ18	150	250
40	165	145	110	85	16	4-Φ18	150	300
50	203	160	125	100	16	4-Φ18	170	350
65	222	180	145	120	18	4-Φ18	195	350
80	241	195	160	135	20	8-Φ18	215	400
100	305	215	180	155	20	8-Φ18	250	500
125	356	245	210	185	22	8-Φ18	265	600
150	394	280	240	210	24	8-Φ23	270	800
200	457	335	295	265	24	12-Φ23	330	800
250	533	405	355	320	26	12-Φ25	450	1300

DN	L	D	D1	D2	b	Y	Z-Φd	H	L0
PN25									
15	130	95	65	45	16	-	4-Φ14	103	100
20	140	105	75	55	16	-	4-Φ14	112	160
25	150	115	85	65	16	-	4-Φ14	123	160
32	165	135	100	78	18	-	4-Φ18	150	250
40	180	145	110	85	18	-	4-Φ18	156	250
50	200	160	125	100	20	-	4-Φ18	172	350
65	220	180	145	120	22	-	8-Φ18	197	350
80	250	195	160	135	22	-	8-Φ18	222	450
100	280	230	190	160	24	-	8-Φ23	253	450
125	320	270	220	188	28	-	8-Φ25	275	600
150	360	300	250	218	30	-	8-Φ25	286	800
200	400	360	310	278	34	-	12-Φ25	340	1200
250	530	425	370	332	36	-	12-Φ30	470	1400

DN	L	D	D1	D2	b	Y	Z-Φd	H	L0
PN40									
15	140	95	65	45	16	40	4-Φ14	103	100
20	152	105	75	55	16	51	4-Φ14	112	160
25	165	115	85	65	16	58	4-Φ14	123	160
32	178	135	100	78	18	66	4-Φ18	150	250
40	190	145	110	85	18	76	4-Φ18	156	250
50	216	160	125	100	20	88	4-Φ18	172	350
65	241	180	145	120	22	110	8-Φ18	197	350
80	283	195	160	135	22	121	8-Φ18	222	450
100	305	230	190	160	24	150	8-Φ23	253	450
125	381	270	220	188	28	176	8-Φ25	275	600
150	403	300	250	218	30	204	8-Φ25	286	800
200	502	375	320	282	38	260	12-Φ30	340	1200
250	568	445	385	345	42	313	12-Φ34	470	1400

# American Standard Floating Ball Valve

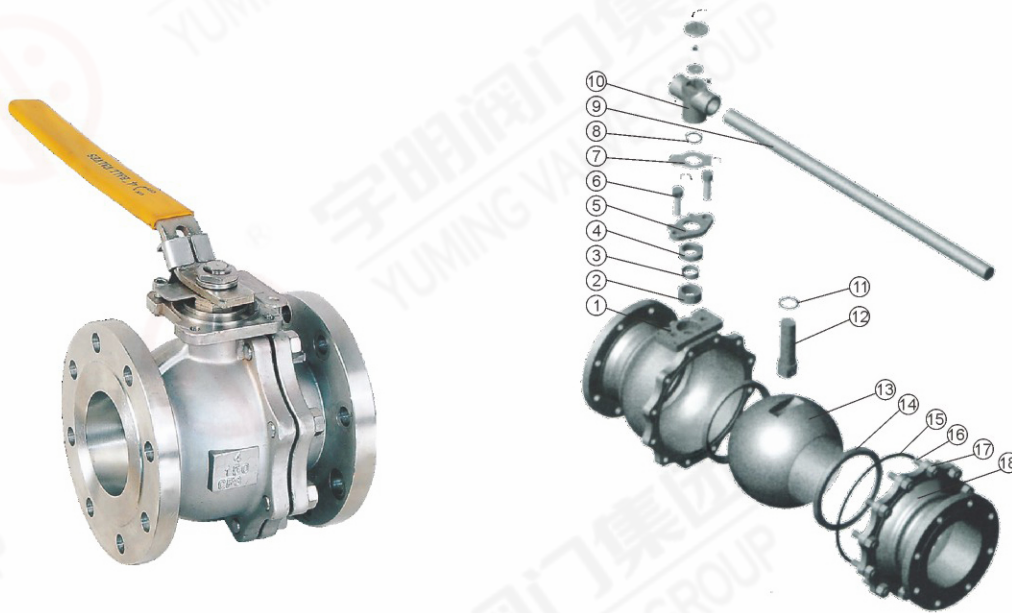

## Main part material

No.	Part Name	Material				
		CF8	CF8M	WCB/13Cr	WCB/304	WCB/316
1	Body	ASTM A351 CF8	ASTM A351 CF8M	ASTM A216 WCB	ASTM A216 WCB	ASTM A216 WCB
2	Packing	PTFE	PTFE	PTFE	PTFE	PTFE
3	Bushing	PTFE	PTFE	PTFE	PTFE	PTFE
4	Packing sleeve	ASTM A182 F304	ASTM A182 F316	ASTM A182 F6a	ASTM A182 F304	ASTM A182 F316
5	Packing plate	ASTM A351 CF8	ASTM A351 CF8M	ASTM A216 WCB	ASTM A216 WCB	ASTM A216 WCB
6	Screws	ASTM A193 B8	ASTM A193 B8M	ASTM A193 B7	ASTM A193 B7	ASTM A193 B7
7	Positioning pieces	stainless steel	stainless steel	carbon steel	carbon steel	carbon steel
8	Retaining ring	stainless steel	stainless steel	carbon steel	carbon steel	carbon steel
9	Wrench	carbon steel	carbon steel	carbon steel	carbon steel	carbon steel
10	Nut	carbon steel	carbon steel	carbon steel	carbon steel	carbon steel
11	Upper seal	PTFE	PTFE	PTFE	PTFE	PTFE
12	Stem	ASTM A182 F304	ASTM A182 F316	ASTM A182 F6a	ASTM A182 F304	ASTM A182 F316
13	Ball	ASTM A182 F304	ASTM A182 F316	ASTM A182 F6a	ASTM A182 F304	ASTM A182 F316
14	Sealing ring	PTFE	PTFE	PTFE	PTFE	PTFE
15	Gasket	PTFE	PTFE	PTFE	PTFE	PTFE
16	Bolt	ASTM A194 8	ASTM A194 8M	ASTM A194 2H	ASTM A194 2H	ASTM A194 2H
17	Nut	ASTM A193 B8	ASTM A193 B8M	ASTM A193 B7	ASTM A193 B7	ASTM A193 B7
18	Bonnet	ASTM A351 CF8	ASTM A351 CF8M	ASTM A216 WCB	ASTM A216 WCB	ASTM A216 WCB

注：表中所列球阀部件材料属普通钢型，我们可根据顾客要求或实际工作环境提供其他不同材料。



# American Standard Floating Ball Valve

● Class150 ● Class300

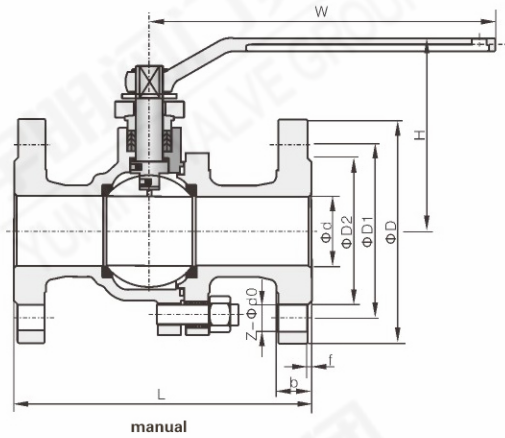

### Executive standard

Design and production:  
 API Spec.6D and API 608  
 Inspection and test:  
 API Spec.6D and API 598  
 RF Flange connection size:  
 ANSI B16.5  
 Structure length:  
 API Spec.6D and ANSI B16.10

## The main connection size

Size		L		d	D	D1	D2	b	f	Z-φd0	W		H	
DN	NPS	RF	RTJ								manual	worm gear rotation	manual	worm gear rotation
<b>Class150</b>														
15	1/2	108	119	14	89	60.5	35	11.5	1.6	4-15	140	-	85	-
20	3/4	117	130	19	98	70	43	11.5	1.6	4-15	140	-	90	-
25	1	127	140	25	108	79.5	51	11.5	1.6	4-15	150	-	99	-
32	1 1/4	140	153	32	117	89	64	13	1.6	4-15	180	-	105	-
40	1 1/2	165	178	38	127	98.5	73	14.5	1.6	4-15	200	-	126	-
50	2	178	191	51	152	120.5	92	16	1.6	4-19	250	-	140	-
65	2 1/2	190	203	64	178	139.5	105	17.5	1.6	4-19	300	-	165	-
80	3	203	216	76	190	152.5	127	19.5	1.6	4-19	350	-	178	-
100	4	229	242	102	229	190.5	157	24	1.6	8-19	500	305	230	380
125	5	356	369	127	254	216	186	24	1.6	8-22	800	305	280	405
150	6	394	407	152	279	241.5	216	25.5	1.6	8-22	800	305	310	460
200	8	457	470	203	343	298.5	270	29	1.6	8-22	1000	305	350	550
250	10	533	546	254	406	362	324	31	1.6	12-25	-	400	-	706
<b>Class300</b>														
15	1/2	140	151	14	95	66.5	35	14.5	1.6	4-15	140	-	85	-
20	3/4	152	165	19	117	82.5	43	16	1.6	4-19	140	-	90	-
25	1	165	178	25	124	89	51	17.5	1.6	4-19	150	-	99	-
32	1 1/4	178	191	32	133	98.5	61	19.5	1.6	4-19	180	-	105	-
40	1 1/2	190	203	38	156	114.5	73	21	1.6	4-22	200	-	126	-
50	2	216	232	51	165	127	92	22.5	1.6	8-19	250	-	142	-
65	2 1/2	241	257	64	190	149	105	25.5	1.6	8-22	300	-	165	-
80	3	283	299	76	210	168.5	127	29	1.6	8-22	350	-	178	330
100	4	305	321	102	254	200	157	32	1.6	8-22	500	305	230	380
125	5	381	397	127	279	235	186	35	1.6	8-22	800	305	280	420
150	6	403	419	152	318	270	216	37	1.6	12-22	800	305	310	480
200	8	502	518	203	381	330	270	41.5	1.6	12-25	1000	305	350	560

# American Standard fixed ball valve

● Class600 ● Class900 ● Class1500

The main connection size

Size		L		d	D	D1	D2	b	f	Z-Φd0	W		H	
DN	NPS	RF	RTJ								Manually	Worm gear rotation	Manually	Worm gear rotation

### Class600

15	1/2	165	164	14	95	66.5	35	14.5	6.4	4-15	140	-	79	-
20	3/4	190	190	19	118	82.5	43	16	6.4	4-19	140	-	83	-
25	1	216	216	25	124	89	51	17.5	6.4	4-19	200	-	114	-
32	1 1/4	229	229	32	133	98.5	64	21	6.4	4-19	200	-	120	-
40	1 1/2	241	241	38	156	114.5	73	22.5	6.4	4-22	250	-	125	-
50	2	292	295	51	165	127	92	25.5	6.4	8-19	300	-	156	-
65	2 1/2	330	333	64	190	149	105	29	6.4	8-22	350	-	172	-
80	3	356	359	76	210	168	127	32	6.4	8-22	500	305	220	370
100	4	432	435	102	273	216	157	38.5	6.4	8-25	650	305	250	400

### Class900

15	1/2	216	216	14	121	82.5	35	22.5	6.4	4-23	150	-	98	-
20	3/4	229	229	20	130	88.9	43	25.5	6.4	4-23	150	-	105	-
25	1	254	254	25	149	101.6	51	29	6.4	4-26	200	-	110	-
32	1 1/4	279	279	32	159	111.1	64	29	6.4	4-26	250	-	120	-
40	1 1/2	305	305	38	178	123.8	73	32	6.4	4-29	250	-	125	-
50	2	368	371	50	216	165.1	92	38.5	6.4	8-26	350	-	160	-

### Class1500

15	1/2	216	216	14	121	82.5	35	22.5	6.4	4-23	182	-	98	-
20	3/4	229	229	20	130	88.9	43	25.5	6.4	4-23	200	-	105	-
25	1	254	254	25	149	101.6	51	29	6.4	4-26	250	-	110	-
32	1 1/4	279	279	32	159	111.1	64	29	6.4	4-26	300	-	120	-
40	1 1/2	305	305	38	178	123.8	73	32	6.4	4-29	350	-	130	-
50	2	368	371	50	216	165.1	92	38.5	6.4	8-26	500	-	160	-



# Fixed ball valve

● Q47F ● Q347F ● Q647F ● Q947F

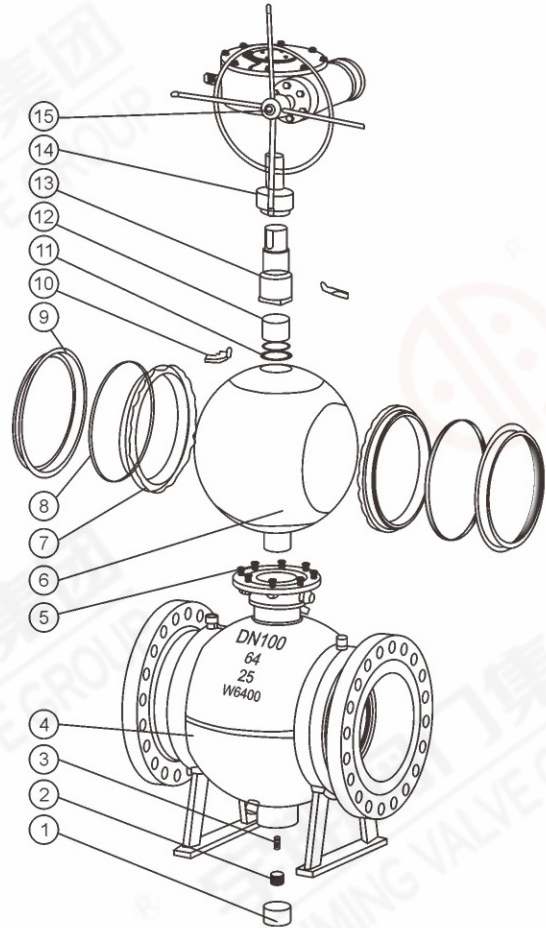

## Application specification

### Executive standard

Design and production: API 6D, GB/T 12237, GB/T 19672

Structure length: API 6D, ASME B 16.10, GB/T 12221

Connection size: ASME B 16.5, ASME B 16.47, GB/T 9113, HG20592

Test and inspection: API 598, API 6D, JB/T 9092, GB/T 19672, GB/T 26480

## Main part material

No.	Part Name	GB	ASTM
1	Bushing	PTFE&Tin bronze	PTFE&Tin bronze
2	Screws	25	A105
3	Spring	60Si2Mn	Inconelx-750
4	Body	25	A105
5	Bolt	35CrMoA	A193-B7
6	Ball	WCB+ENP	WCB+ENP
7	Seat	25	A105
8	seal ring	PTFE	PTFE
9	Disc spring	60Si2Mn	AISI 9260
10	Valve seat rotary drive	assembly	
11	Valve stem seal	PTFE	PTFE
12	Bushing	PTFE&Tin bronze	PTFE&Tin bronze
13	Upper valve stem	1Cr13	A182-F6a
14	Connection sleeve	45	AISIC 1045
15	Drive mechanism	assembly	

注：抗硫型阀门该零件的材质ASTM(A276-321);

抗硫型阀门该零件材质为ASTM(A182-304, CF8+Ni.P); 系列阀门主要零部件及密封面材质可根据实际工况条件或用户特殊要求设计选用。

# Fixed ball valve

- Q347F/H/Y
- Q647F/H/Y
- Q947F/H/Y

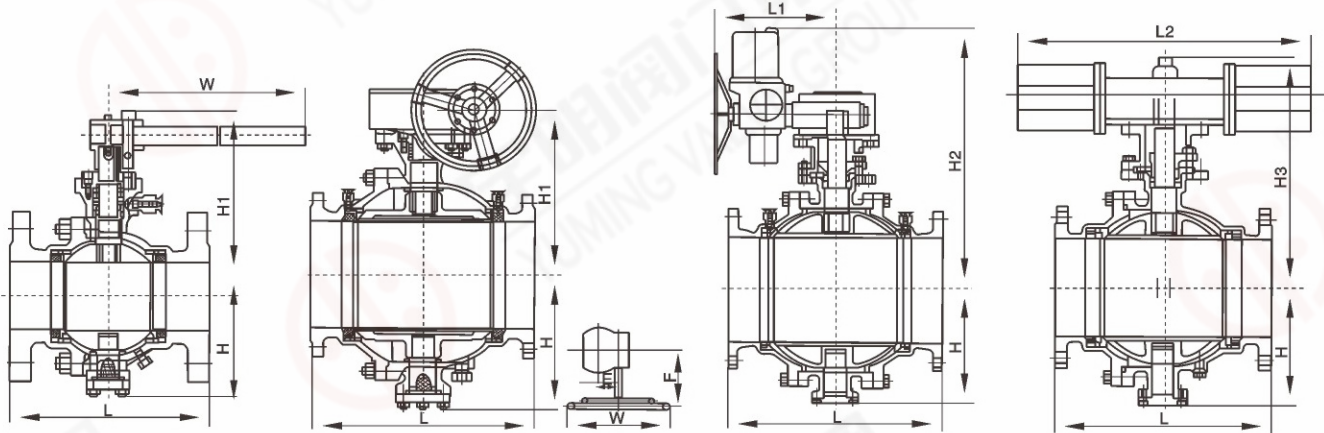

## The main connection size

Size	d <sub>1</sub>	L	H	Manual				Electric		Pneumatic	
				H1	E	F	W	H2	L1	H3	L2
<b>PN16</b>											
25	25	165	50	75	-	-	160	-	-	215	200
32	32	180	55	85	-	-	160	-	-	240	270
40	40	190	80	95	-	-	230	-	-	264	270
50	50	216	102	107	-	-	230	-	-	274	270
65	65	241	114	125	-	-	400	-	-	379	405
80	80	283	127	152	-	-	400	-	-	389	405
100	100	305	152	178	-	-	650	-	-	479	405
125	125	356	184	300	-	-	1050	-	-	552	576
150	150	394	219	330	-	-	1050	554	235	666	776
200	200	457	273	398	116	350	600	600	235	736	776
250	250	533	360	495	116	350	600	652	235	926	776
300	300	610	395	580	171	400	800	760	259	1059	1060
350	337	686	430	625	171	420	800	770	400	1127	1060
400	387	762	470	670	257	400	800	830	400	1393	1360
450	438	864	550	698	257	420	800	-	-	1468	1360
500	489	914	580	840	257	400	800	940	410	1538	1360
600	591	1067	700	1050	150	410	800	940	410	1538	1360
700	686	1245	800	1100	83	650	800	1115	410	1450	2840
<b>PN25</b>											
25	25	165	50	75	-	-	160	-	-	215	200
32	32	180	55	85	-	-	160	-	-	240	270
40	40	190	80	95	-	-	230	-	-	264	270
50	50	216	102	107	-	-	230	-	-	340	405
65	65	241	114	125	-	-	400	-	-	379	405
80	80	283	127	152	-	-	400	-	-	452	574
100	100	305	152	178	-	-	650	-	-	479	574
125	125	381	184	300	-	-	1050	-	-	646	756
150	150	403	219	330	-	-	1050	235	74	666	756
200	200	502	273	398	116	350	600	235	350	814	1060
250	250	533	360	495	116	350	800	400	350	1002	1060
300	300	610	395	580	171	420	800	400	420	1059	1060
350	337	686	430	625	171	420	600	410	420	1150	1360
400	387	838	470	670	257	400	800	410	400	1205	1360
450	438	814	550	698	257	400	800	-	-	1250	2840
500	489	991	580	840	257	400	800	420	400	1295	2840
600	591	1143	700	1050	150	410	800	690	410	1390	3300
700	686	1346	800	1100	83	650	800	690	650	1470	3300



# Fixed ball valve

- Q347F/H/Y
- Q647F/H/Y
- Q947F/H/Y

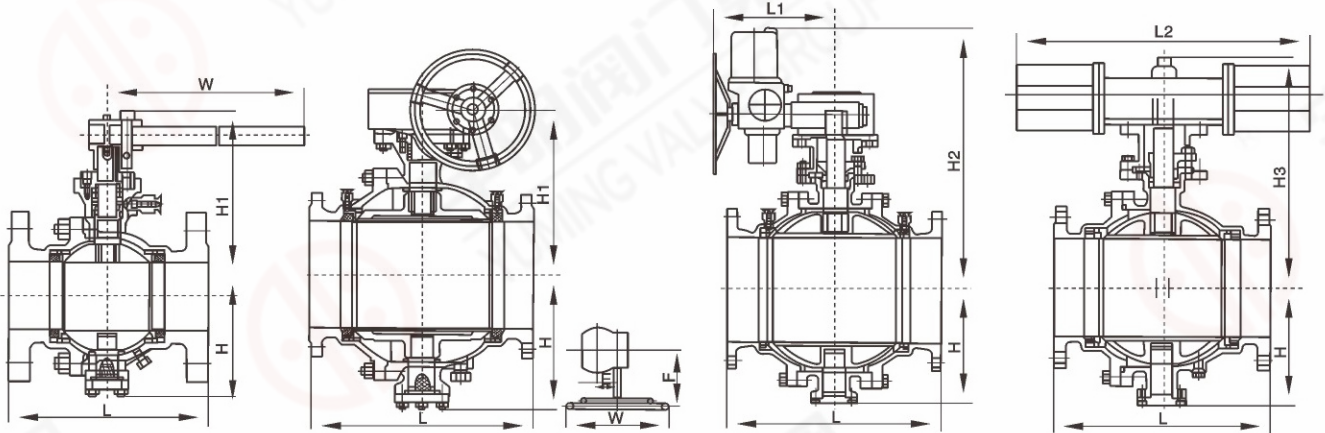

## The main connection size

Size	d1	L	H	Manual				Electric		Pneumatic	
				H1	E	F	W	H2	L1	H3	L2
<b>PN64</b>											
25	25	165	50	75	-	-	160	-	-	215	200
32	32	180	55	85	-	-	160	-	-	240	270
40	40	190	80	95	-	-	230	-	-	264	270
50	50	216	102	107	-	-	230	-	-	274	270
65	65	241	114	125	-	-	400	-	-	379	405
80	80	283	127	152	-	-	400	-	-	389	405
100	100	305	152	178	-	-	650	-	-	479	405
125	125	356	184	300	-	-	1050	-	-	552	576
150	150	394	219	330	-	-	1050	554	235	666	776
200	200	457	273	398	116	350	600	600	235	736	776
250	250	533	360	495	116	350	600	652	235	926	776
300	300	610	395	580	171	400	800	760	259	1059	1060
350	337	686	430	625	171	420	800	770	400	1127	1060
400	387	762	470	670	257	400	800	830	400	1393	1360
450	438	864	550	698	257	420	800	-	-	1468	1360
500	489	914	580	840	257	400	800	940	410	1538	1360
600	591	1067	700	1050	150	410	800	940	410	1538	1360
700	686	1245	800	1100	83	650	800	1115	410	1450	2840
<b>PN100</b>											
25	25	165	50	75	-	-	160	-	-	215	200
32	32	180	55	85	-	-	160	-	-	240	270
40	40	190	80	95	-	-	230	-	-	264	270
50	50	216	102	107	-	-	230	-	-	340	405
65	65	241	114	125	-	-	400	-	-	379	405
80	80	283	127	152	-	-	400	-	-	452	574
100	100	305	152	178	-	-	650	-	-	479	574
125	125	381	184	300	-	-	1050	-	-	646	756
150	150	403	219	330	-	-	1050	235	74	666	756
200	200	502	273	398	116	350	600	235	350	814	1060
250	250	533	360	495	116	350	800	400	350	1002	1060
300	300	610	395	580	171	420	800	400	420	1059	1060
350	337	686	430	625	171	420	600	410	420	1150	1360
400	387	838	470	670	257	400	800	410	400	1205	1360
450	438	814	550	698	257	400	800	-	-	1250	2840
500	489	991	580	840	257	400	800	420	400	1295	2840
600	591	1143	700	1050	150	410	800	690	410	1390	3300
700	686	1346	800	1100	83	650	800	690	650	1470	3300

# Metal sealed floating ball valve

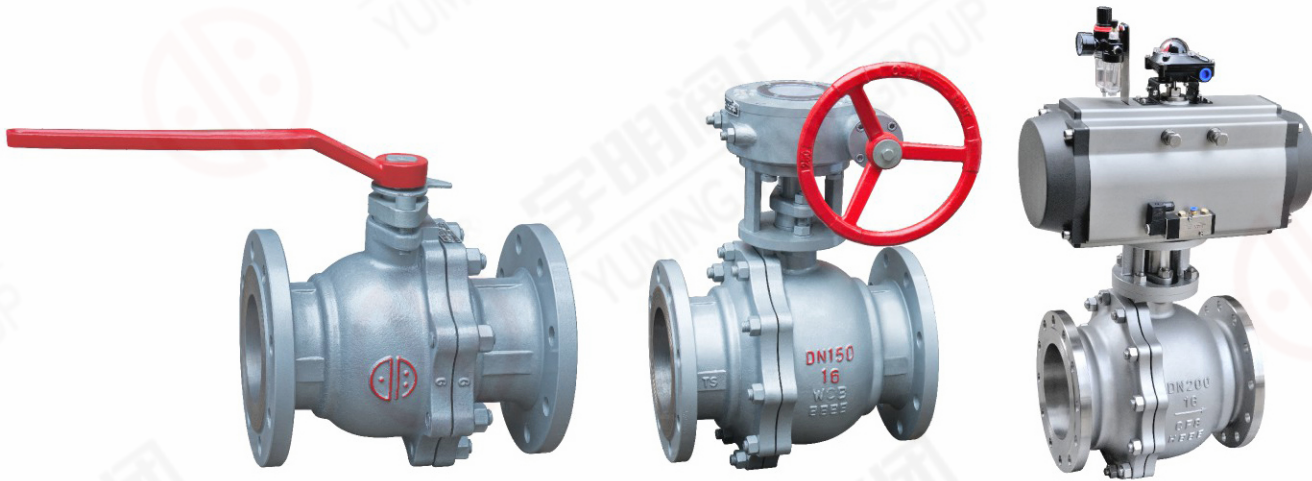

## The main purpose

In general, ball valve seat materials are made of non-metallic materials such as PTFE, which limits the use of ball valves. Usually ball valves cannot be used in high temperature conditions and the media is particulate and ash removal systems. In response to this situation, after many years of hard work, research and development of metal sealed ball valve. Including floating and fixed, so that the ball valve in the oil, petrochemical, metallurgy, polysilicon, electricity and other industries have been widely used.

## Structural design features

In addition to the metal seal ball valve to prevent erroneous operation, to prevent the valve stem out, set the drive device Apart from the installation platform and other structural features, it also has the following features:

### Advanced ball and valve seat hardening technology

The sphere and seat of the metal sealing ball valve are completely sealed by metal. In order to ensure the reliable sealing of the valve under various temperatures and pressures, the user's different working conditions and requirements are used. Can use a variety of advanced ball and valve seat hardening techniques, including supersonic spray, nickel-based spray welding, cousin special hardening, carbide spray welding and the use of high-strength hard ceramic materials, ball and valve seat surface hardness Can reach HRC60 or more. Up to HRC74 or more. Sealing surface material temperature can generally be 540 °C. Up to 980°C. The sealing surface material also has good resistance to friction, impact and other properties. Metal sealed ball valve can be applied to most of the harsh.

### Prevents the valve from locking at high temperatures

Under high temperature conditions, due to thermal expansion, the ball and the valve seat are easily locked and the valve cannot be opened. Metal sealed ball valve uses a disc spring or spring-loaded patented sealing structure, the thermal expansion of the parts at high temperatures can be absorbed by the disc spring or spring, it can ensure that the valve will not rise at high temperatures, and can be flexible at high temperatures close.

### Excellent sealing performance

A unique ball valve grinding process is used to rotate the sphere and grinding tool in different directions in space. The surface of the sphere achieves extremely high roundness and smoothness, and the sealing performance of the valve completely meets or exceeds the standard requirement.

### Anti-static structure design

The valve body, valve seat, sphere and other metal parts of the metal sealing ball valve are in close contact. Naturally formed electrostatic channels. Therefore, the metal hard seal ball valve does not require a special anti-static device.

### Double blocking and bleeder function

Metal seal fixed ball valve generally adopts ball front seat sealing structure. The two valve seats of the metal hard seal fixed ball valve independently cut off the media at the inlet and outlet ends to achieve a double blocking function. When the ball valve is closed, both ends of the valve are compressed at the same time. The valve cavity and the two ends of the channel can also be blocked from each other. The remaining medium in the middle chamber can be discharged through the drain valve.



# Metal sealed floating ball valve

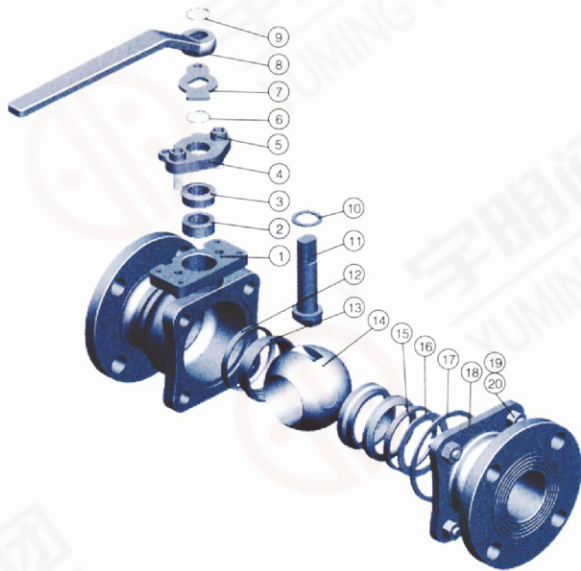

## specifications

design standards	GB/T21385
structure length	GB/T12221
flange size	GB/T9113, HG20592
test and inspection	GB/T26480, JB/T9092

## Main part material

No.	Part Name	Material				
		WCB/13Cr	WCB/304	WCB/316	CF8	CF8M
1	Body	ASTM A216 WCB	ASTM A216 WCB	ASTM A216 WCB	ASTM A351 CF8	ASTM A351 CF8M
2	Packing	graphite	graphite	graphite	graphite	graphite
3	Packing sleeve	ASTM A 182 F6a	ASTM A 182 F304	ASTM A 182 F316	ASTM A 182 F304	ASTM A 182 F316
4	Packing gland	ASTM A216 WCB	ASTM A216 WCB	ASTM A216 WCB	ASTM A351 CF8	ASTM A351 CF8M
5	Packing bolt	ASTM A 193B7	ASTM A 193B7	ASTM A 193B7	ASTM A 193B8	ASTM A 193 B8M
6	Retaining ring	Carbon steel	Carbon steel	Carbon steel	stainless steel	stainless steel
7	Positioning pieces	Carbon steel	Carbon steel	Carbon steel	stainless steel	stainless steel
8	lever	Carbon steel	Carbon steel	Carbon steel	Carbon steel	Carbon steel
9	Retaining ring	Carbon steel	Carbon steel	Carbon steel	stainless steel	stainless steel
10	Upper seal	304+graphite	304+graphite	316+graphite	304+graphite	316+graphite
11	Stem	ASTM A 182 F6a	ASTM A 182 F6a	ASTM A 182 F316	ASTM A 182 F304	ASTM A 182 F316
12	Seat seal	graphite	graphite	graphite	graphite	graphite
13	Seat	ASTM A 182 F6a+WC-Co	ASTM A 182 F304+WC-Co	ASTM A 182 F316	ASTM A 182 F304+WC-Co	ASTM A 182 F316+WC-Co
14	Ball	ASTM A 182 F6a+WC-Co	ASTM A 182 F304+WC-Co	ASTM A 182 F316	ASTM A 182 F304+WC-Co	ASTM A 182 F316+WC-Co
15	Pressure ring	ASTM A182 F6a	ASTM A182 F304	ASTM A182 F316	ASTM A182 F304	ASTM A182 F316
16	Disc spring	Inconel 750	Inconel 750	Inconel 750	Inconel 750	Inconel 750
17	Gasket	304+graphite	304+graphite	316+graphite	304+graphite	316+graphite
18	Bonnet	ASTM A216 WCB	ASTM A216 WCB	ASTM A216 WCB	ASTM A351CF8	ASTM A351 CF8M
19	Body bolt	ASTM A193 B7	ASTM A193 B7	ASTM A193 B7	ASTM A193 B8	ASTM A193 B8M
20	Body nut	ASTM A194 2H	ASTM A194 2H	ASTM A194 2H	ASTM A194 8	ASTM A194 8M

注：本表为常规法兰连接蜗轮蜗杆传动固定球阀的型号编制、主要零件材料及适用工况，其他要求及基型号编号编制见球阀型号编制方法。

# Heating welding ball valve



## Application

Applicable to city gas pipelines, large-scale heating equipment pipelines, and various fluids in steel plants, gas heat supply, and fuel supply pipelines.

## Structural characteristics

The valve body is formed by steel plate and welded together as a whole to avoid any possible media leakage. The spring-loaded valve seat assembly structure adapts strongly to changes in pressure and temperature to ensure close contact between the sealing ring and the ball. In order to ensure the sealing under the premise of the valve opening and closing is flexible, easy to operate, the ball and the stem through a precision machine tool processing, reducing the friction coefficient between the contact surface, and further improve the sealing performance of the valve emergency operating torque.

## Specifications

Design and manufacture		API 6D, ASME B76.34, API 608, MSS-SP-72
Structure length		按厂标
Connector	Flange connection	ASME B16.5
	Butt welding connection	ASME B16.25
Test and inspection		AP1598. AP16D
Fire test		AP1607. AP16FA

注：阀门连接端对焊端尺寸可按用户要求设计制造。

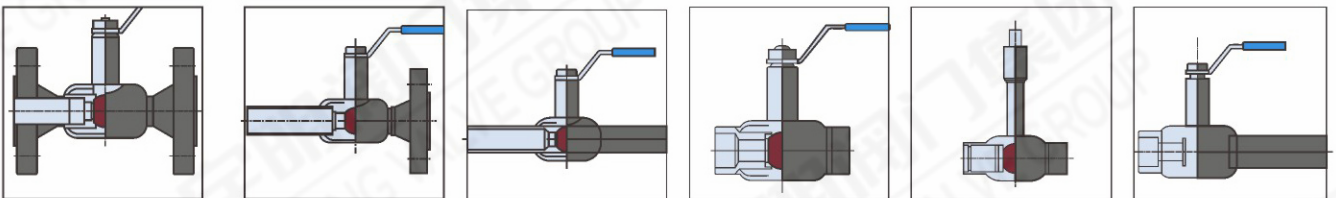

## Operation method

Yuming can provide various types of valve actuators: manual, pneumatic, electric, hydraulic, and gas-liquid linkage. The specific model is based on the valve moment selection.

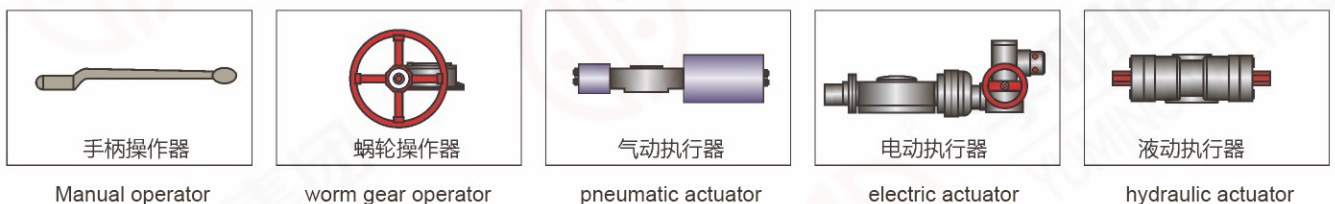



# Heating welding ball valve

Heating all welded fixed ball valve (full path):

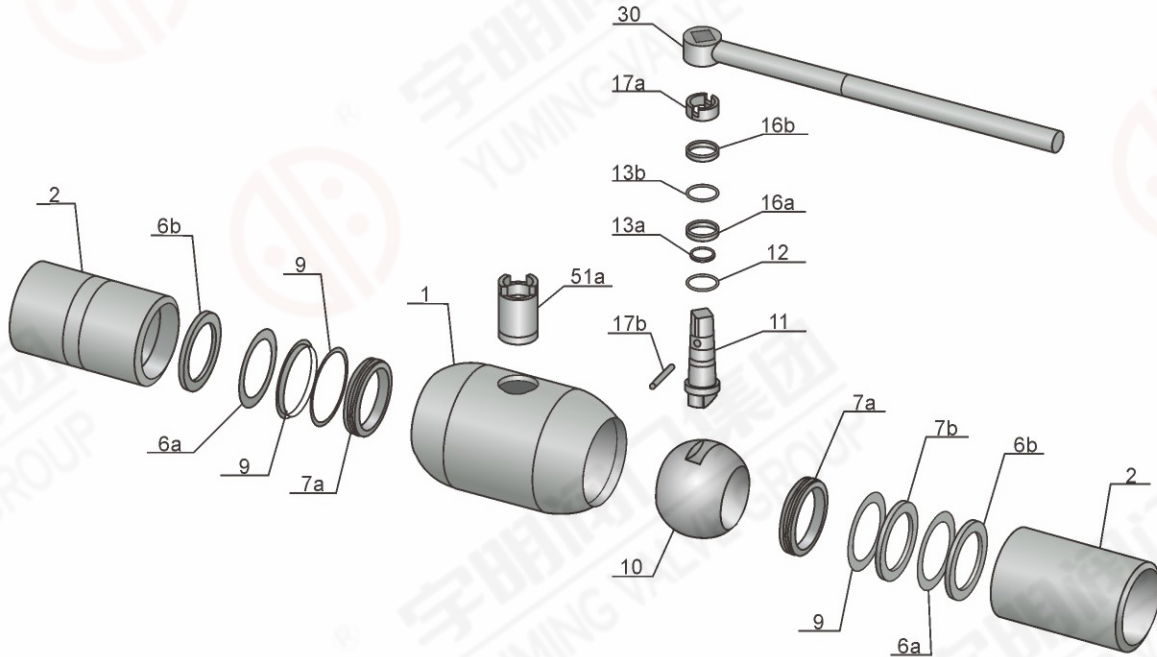

Heating all welded fixed ball valve (standard diameter):

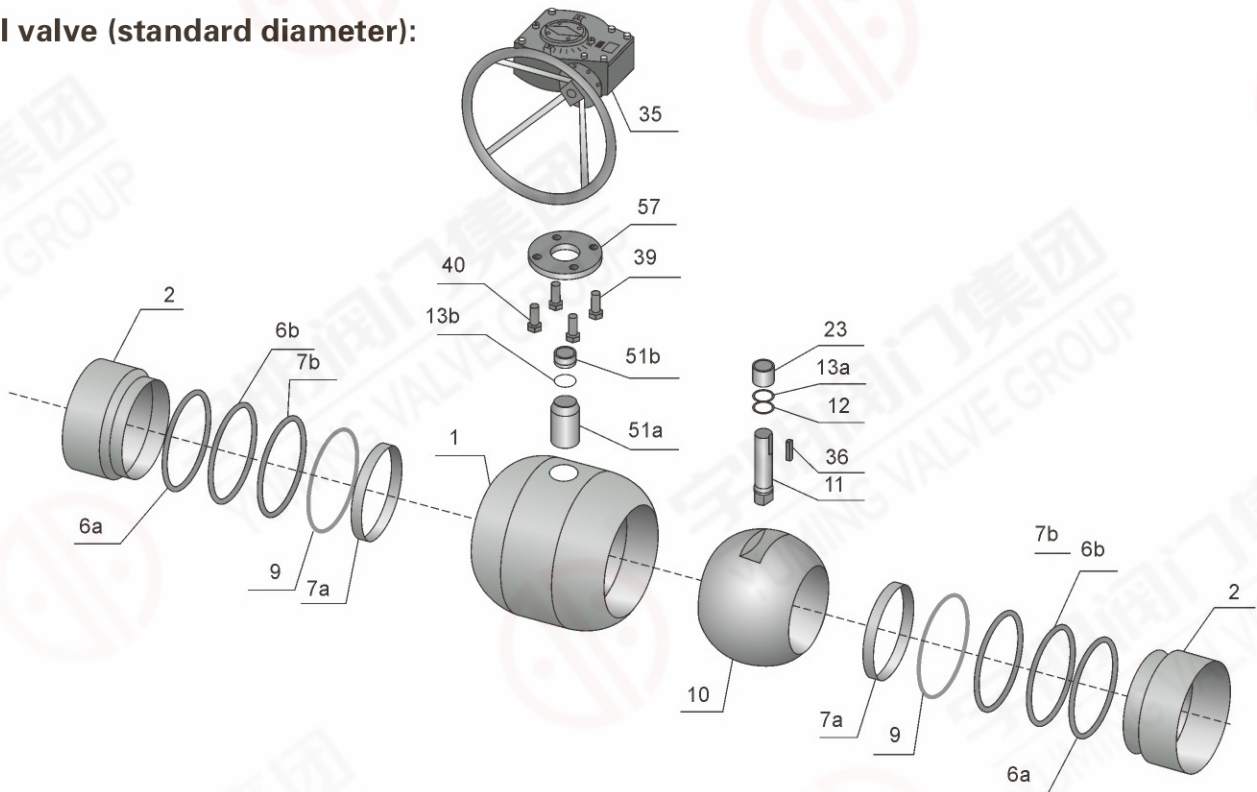

# Heating welding ball valve

## Main part material

No.	Part Name	Material
1	Medium body	20#
2	Take over	20#
6a	Butterfly spring	65Mn
6b	Baffle	A105
7a	Sealing ring	PTFE+25%C
7b	Fire circle	SS304
9	O-ring	VITON
10	Ball	SS304
11	Stem	2Cr13
12	Thrust washer	PTFE
13a	O-ring	VITON
13b	O-ring	VITON
16a	Packing	PTFE
16b	Packing	PTFE
17a	Positioning cover	Ss304
17b	Round pin	20#
23	Sliding bearing	20#+PTFE
30	Handle	20#
35	Manual operator	组合件
36	Pin	45#
39	Elastic washer	65Mn
40	Hex Bolts	20#
51a	Valve stem connector	20#
51b	Thread glands	20#



# Heating welding ball valve

Heating all welded fixed ball valve (full path):

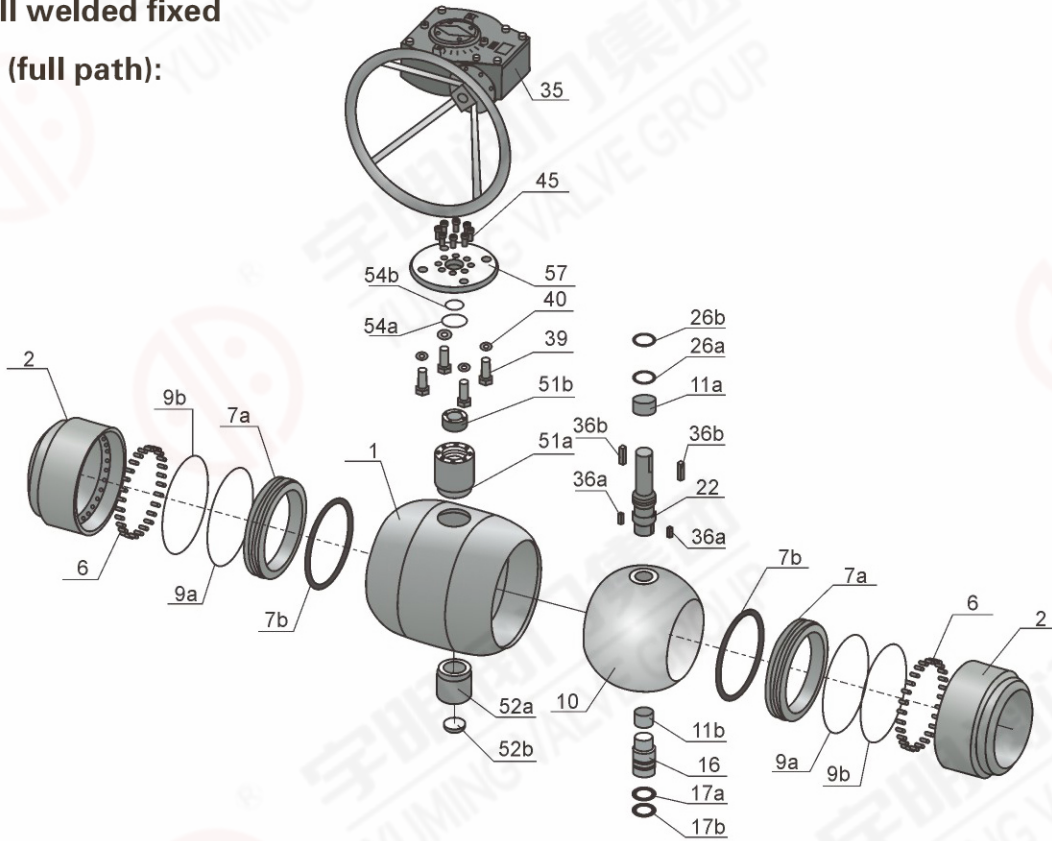

Heating all welded fixed ball valve (standard diameter):

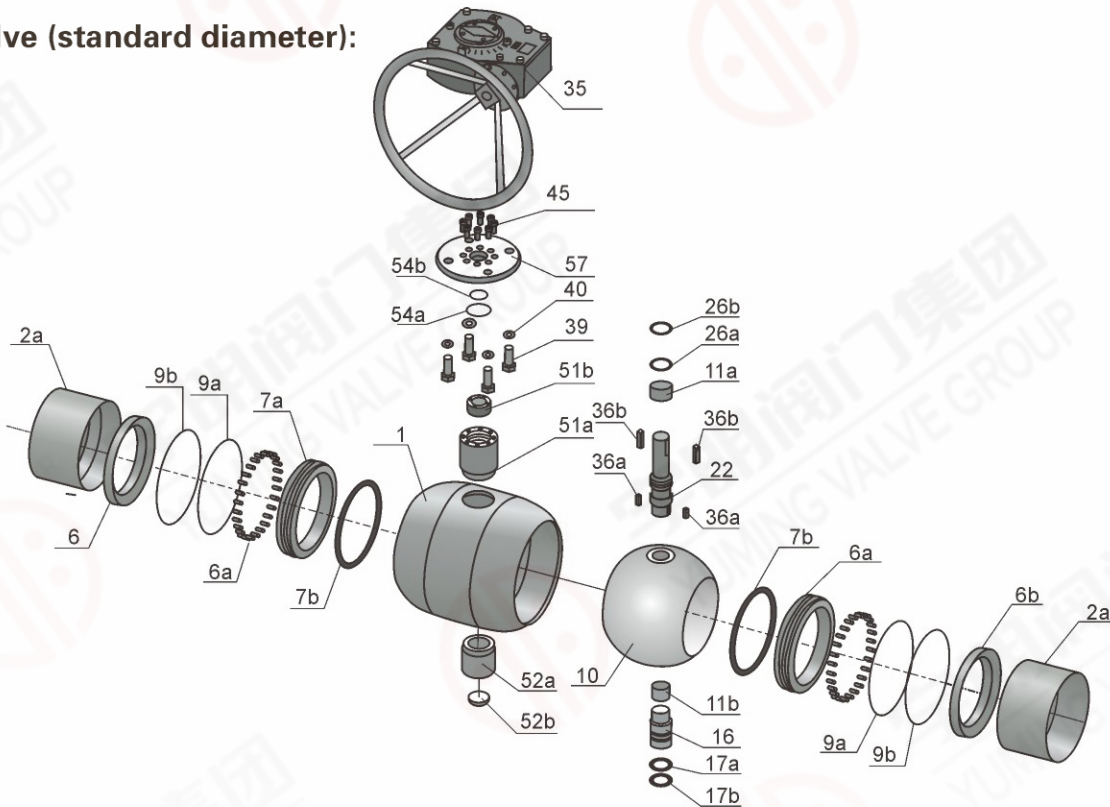

# Heating welding ball valve

## Main part material

NO.	Part Name	Material
1	Medium body	20#
2a	Take over	20#
2b	Flange	A105
6a	Butterfly spring	60Si2Mn
6b	Baffle	A105
7a	Seat support ring	A105
7b	Sealing ring	PTFE+25%C
9a	O-ring	VITON
9b	O-ring	VITON
10	Ball	20#+HCr
11a	Sliding bearing	20#+PTFE
11b	Sliding bearing	20#+PTFE
16	Fixed axis	A105
17a	O-ring	VITON
17b	O-ring	VITON
22	Stem	2Cr13
26a	O-ring	VITON
26b	O-ring	VITON
35	Manual operator	组合件
36	Pin	45#
39	Elastic washer	65Mn
40	Hex Bolts	A193-B7
45	Socket head cap screws	A193-B7
51a	Valve stem connector	20#
51b	Thread glands	20#
52a	Fixed sleeve	20#
52b	Closure	20#
54a	O-ring	VITON
54b	O-ring	VITON
57	Land	20"



# Heating welding ball valve

● 全通径

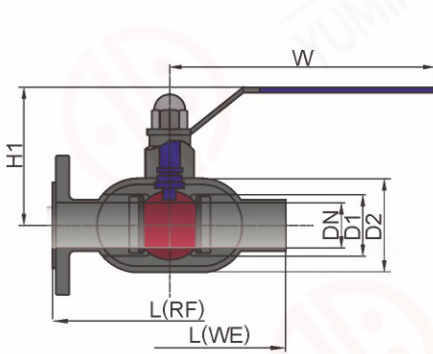

Handle operation

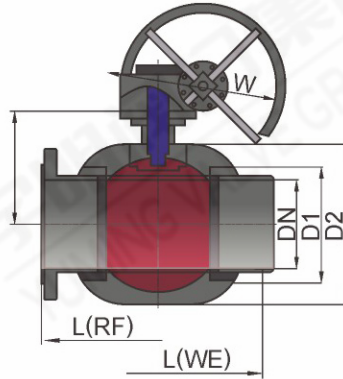

Worm gear operation

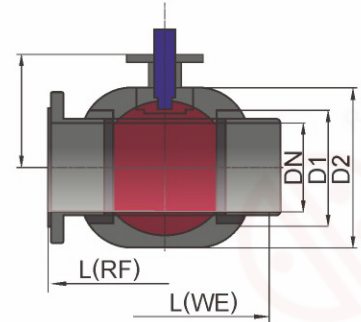

Light pole with plate,BSMP

## Main part material

单位unit:mm

DN	L(RF)	L(WE)	D1	D2	H1(手柄)	H1(蜗轮)	W(手柄)	W(蜗轮)
Q61F/Q361F-Q41F/Q341F PN16/PN25/PN40								
15	150	210	27	48	64		129	
20	160	230	34	60	76		159	
25	180	230	42	76	85		159	
32	200	260	48	89	95		245	
40	230	300	60	89	124		245	
50	270	300	76	114	162		320	
65	280	300	89	140	175		320	
80	300	325	114	168	192	169	450	
100	350	325	141	203	205	183	450	230
125	350	350	168	219	225	203	450	230
150	400	400	219	273	245	224	1000	230
200	502	521	273	351	285	262	1000	320
250	568	560	325	426	348	322	1500	350
300	648	635	377	508		355		350

# Heating welding ball valve

● 标准径

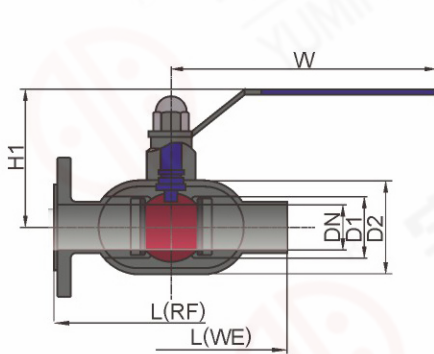

Handle operation

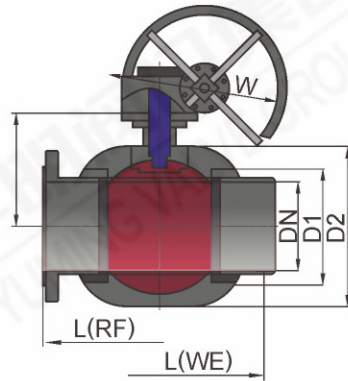

Worm gear operation

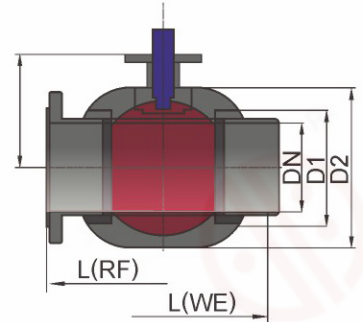

Light pole with plate,BSMP

## Main part material

unit:mm

DN	L(RF)	L(WE)	D1	D2	H1(手柄)	H1(蜗轮)	W(手柄)	W(蜗轮)
Q61F/Q361F-Q41F/Q341F PN16/PN25/PN40								
15×10	130	210	21	42	64		129	
20×15	150	230	27	48	64		129	
25×20	160	230	34	60	76		159	
32×25	180	260	42	76	85		159	
40×32	200	300	48	89	95		245	
50×40	230	300	60	89	124		245	
65×50	270	300	76	114	162		320	
80×65	280	300	89	140	175		320	
100×80	300	325	114	168	192	169	450	230
125×100	350	325	141	203	205	183	450	230
150×125	400	350	168	219	225	203	450	230
200×150	450	400	219	273	245	224	1000	280
250 × 200	568	560	273	351	285	262	1000	320
300×250	648	635	325	426	348	322	1500	320
350 × 300	762	762	377	508		355		400



# Heating welding fixed ball valve

● 全通径

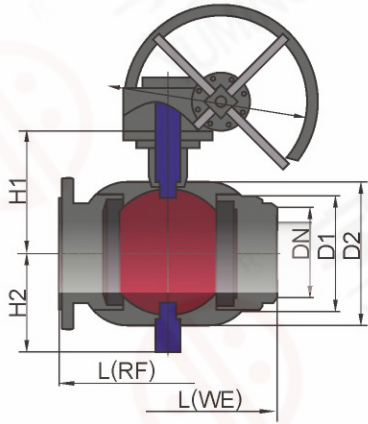

Worm gear operation

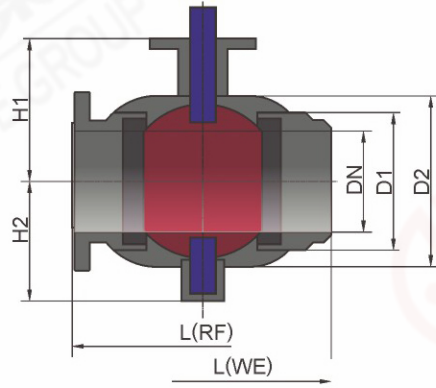

Light pole with plate, BSMP

## Main part material

unit:mm

DN	L(RF)	L(WE)	D1	D2	H1	H2	Torque W
Q367F/Q347F PN16/PN25/PN40							
150	403	457	219	273	246	193	280
200	502	521	273	351	285	238	320
250	568	560	325	426	323	278	320
300	648	635	377	508	365	315	400
350	762	762	426	580	410	370	400
400	838	838	480	675	457	425	450
450	914	914	530	740	495	465	450
500	991	991	630	805	540	495	500
600	1143	1143	735	975	640	580	500
700	1346	1346	830	1130	715	660	500
800	1524	1524	930	1270	785	730	500
900	1727	1727	1036	1425	860	820	800
1000	1900	1840	1236	1625	970	920	800
1200	2200	2100	1600	1950	1350	1150	1000

# Heating welding fixed ball valve

● 标准径

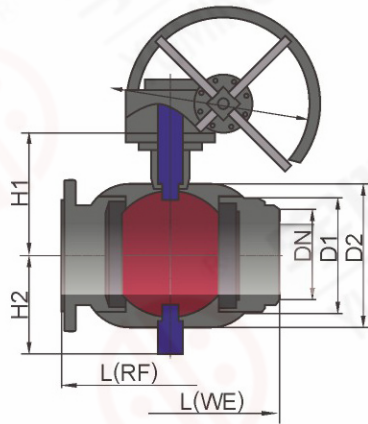

Worm gear operation

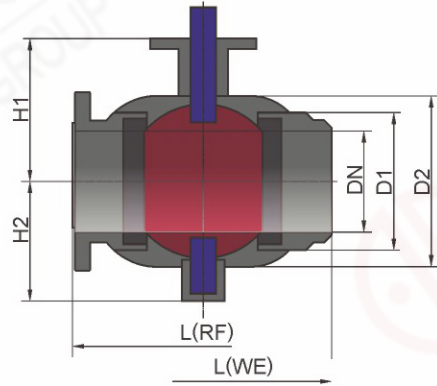

Light pole with plate,BSMP

## Main part material

unit:mm

DN	L(RF)	L(WE)	D1	D2	H1	H2	W
Q367F/Q347F PN16/PN25/PN40							
150×125	403	457	168	219	200	151	230
200×150	502	521	219	273	246	193	280
250×200	568	560	273	351	285	238	320
300×250	648	635	325	426	323	278	320
350×300	762	762	377	508	365	315	400
400×350	838	838	426	580	410	370	400
450×400	914	914	480	675	457	425	450
500×450	991	991	530	740	495	465	450
600×500	1143	1143	630	805	540	495	500
700×600	1346	1346	735	975	640	580	500
800×700	1524	1524	830	1130	715	660	500
900×800	1727	1727	930	1270	785	730	500
1000×900	1900	1840	1036	1425	860	820	800
1200×1000	2180	2100	1236	1625	970	920	800



# Special welded flanged ball valve for heating

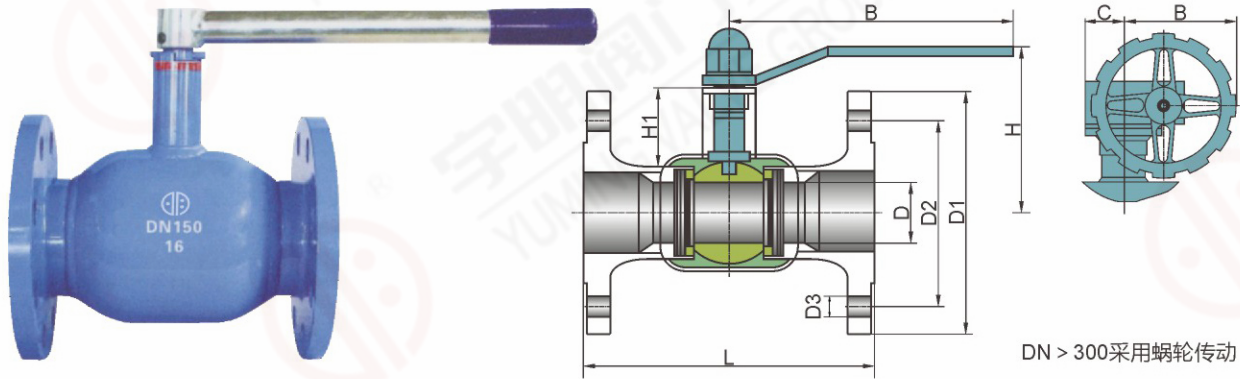

## Main part material

unit:mm

DN	PN	L	D	D1	D2	H	B	C	H1	Torque (N.M)
PN25/PN40										
15	40	130	10	95	14	98	145	-	22	1-2
20	40	150	15	105	14	103	145	-	23	3-4
25	40	160	20	115	14	118	145	-	34	5-7
32	40	180	25	140	18	121	145	-	34	8-11
40	40	200	32	150	18	120	190	-	43	12-18
50	40	230	40	165	18	127	190	-	44	25-32
65	25	270	50	185	18	170	280	-	71	38-45
80	25	280	65	200	18	185	280	-	77	55-65
100	25	300	80	235	22	210	280	-	102	110-120
125	25	325	100	270	26	253	400	-	102	200-250
150	25	350	125	300	26	273	600	-	107	300-340
200	25	400	150	360	26	300	900	-	123	450-480
250	25	530	200	425	30	345	1200	-	122	750-800
300	25	630	250	485	30	572	280	193	155	900-950
350	25	690	300	555	33	697	325	150	187	1200-1300
400	25	762	350	620	36	764	466	175	221	1900-2000

# Cast iron gate valve

● Z45T-10/16 ● Z41T-10/16

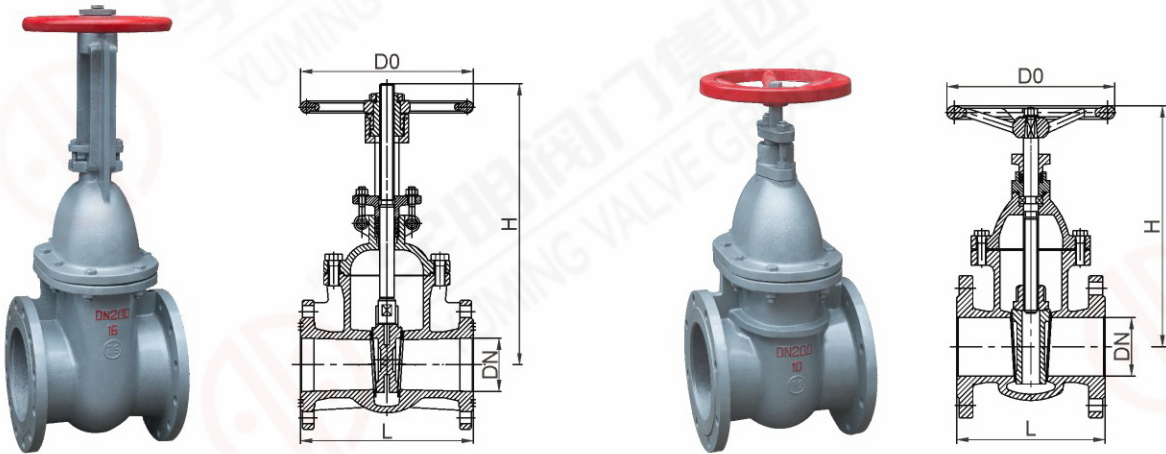

Z45T-10/16 Z41T-10/16 Applicable to the temperature of 0 ~ 100 °C water medium pipeline, for the opening and closing.

### Structural features:

This type of valve adopts metal sealing structure, disassembly and assembly, convenient maintenance, flexible opening and closing, and good sealing performance.

### Major performance specifications

model	test pressure MPa		suitable medium	suitable temperature
	shell	seal		
Z45T-10 Z41T-10	1.5	1.1	water	0~100°C
Z45T-16 Z41T-16	2.4	1.8		

### Main part material

model	part name	bady bonnet	stem	disc	stem nut
Z45T-10/16 Z41T-10/16	material	HT200	Carbon steel aluminum plating 20Cr13	HT200 Surfacing copper	Ductile iron /copper

### The main connection size

model	Nominal pressure	Symbols in the figure	DN(mm)													
			40	50	65	80	100	125	150	200	250	300	350	400	450	500
Z45T	PN10	L	165	178	190	203	229	254	267	292	330	356	381	406	432	457
		D0	160	160	160	230	230	240	240	280	320	360	400	500	500	720
		H	256	285	294	330	364	445	477	552	675	770	968	1090	1175	1414
Z45T	PN16	L	165	178	190	203	229	254	267	292	-	-	-	-	-	-
		D0	160	160	160	230	230	240	240	280	-	-	-	-	-	-
		H	256	285	294	330	364	445	477	552	-	-	-	-	-	-
Z41T Z45T (B型)	PN10	L	165	178	190	203	229	254	280	330	380	420	450	480	510	540
		D0	135	180	180	200	200	240	240	320	320	400	400	500	500	500
		H	245	286	320	373	428	513	582	730	897	1032	1170	1330	1460	1727
Z41T Z45T (B型)	PN16	L	165	178	190	203	229	254	280	330	-	-	-	-	-	-
		D0	135	180	180	200	200	240	240	320	-	-	-	-	-	-
		H	245	286	320	373	428	513	582	730	-	-	-	-	-	-



# Soft seal gate valve

● Z41X-10Q/16Q ● Z45X-10Q/16Q

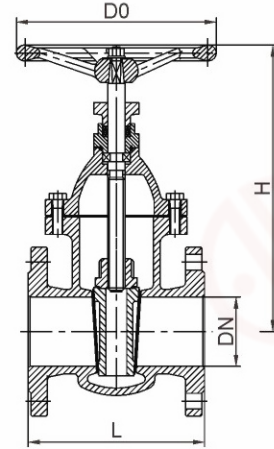

## Structural features

1. The valve body adopts precision casting. The round-slide valve seat and the rubber-covered gate plate are tightly closed to achieve no leakage, no material, smooth flow channel, and light and flexible opening and closing.
2. The body cavity of the valve adopts non-toxic ring gas resin, and the inner surface and the outer surface of the gate plate are completely covered with rubber, which has no pollution to the water quality, and is environmentally friendly and energy-saving.

## Major performance specifications

model	test pressure MPa		suitable medium	suitable temperature
	shell	seal		
Z45X-10Q Z41X-10Q	1.5	1.1	water /Sewage	-10~60°C
Z45X-16Q Z41X-16Q	2.4	1.76		

## Main part material

model	part name	body bonnet	stem	disc	stem nut
Z45X-16Q Z41X-16Q	material	QT400	Carbon steel aluminum plating 20Cr13	QT400 Cover rubber	Ductile iron /copper

## The main connection size

model	Nominal pressure	Symbols in the figure	DN(mm)													
			40	50	65	80	100	125	150	200	250	300	350	400	450	500
Z41X Z45X	1.0	L	165	178	190	203	229	254	267	292	330	356	381	406	432	457
		D0	160	160	160	230	230	240	240	280	320	360	400	500	500	720
		H	256	285	294	330	364	445	477	552	675	770	968	1090	1175	1414
Z41X Z45X	1.6	L	165	178	190	203	230	255	280	330	380	420	450	480	-	-
		D0	160	160	160	230	250	320	320	360	400	400	400	500	-	-
		H	256	285	294	330	380	430	500	600	710	770	830	930	-	-

# Cast steel gate valve

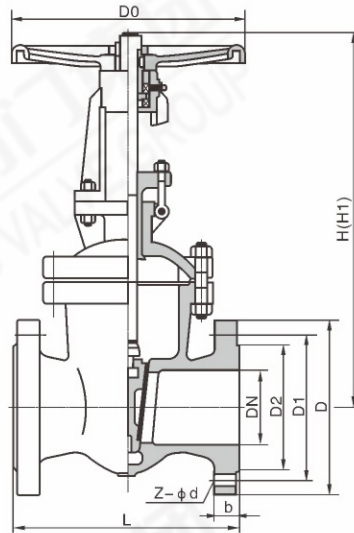

DN 40-100



DN 150-200



DN 40-80

## Product performance standards

Design specification	Structure length	Connection flange	Test and inspection	Pressure-Temp	Product Identification
GB/T12234	GB/T12221	GB/T9113	JB/T9092, GB/T26480	GB/T12224	GB/T12220

## Product performance specifications

### Test pressure

Nominal Pressure PN(MPa)	Shell	Test pressure (MPa)		Top Seal
		Seal(H M)	Seal(A M)	
1.6	2.4	1.8	0.6	1.8
2.5	3.8	2.8	0.6	2.8
4.0	6.0	4.4	0.6	4.4
6.4	9.6	7.04	0.6	7.04
10.0	15.0	11.0	0.6	11.0
16.0	24.0	18.0	0.6	18.0

### Suitable media and applicable temperature

Shell material	Suitable media	Applicable Temp
Carbon steel(C)	water/steam/oil	-29~425
Chrome nickel titanium steel(P)	Nitric acid	≤200
Chrome-Molybdenum-titanium Steel(P)	Acetic acid	≤200
Chrome-molybdenum steel(l)	water/steam/oil	≤550

## Main material parts

Body/Bonnet	Disc/Seat	Stem	Stem nut	Packing	Handwheel
WCB	20Cr13	20Cr13	Brass	Flexible graphite	Iron



# Cast steel gate valve

● Z40/Z41/KZ41

Main connection size

unit:mm

SIZE DN	L	D	D1	D2	b	f	Z-d	H	H1	Do
	<b>Z40H Z41Y -16</b>	<b>Z40 Z41 Y-16P</b>	<b>Z40 Z41 Y-16R</b>	<b>Z40 Z41 W-16P</b>	<b>Z40 Z41 W-16R</b>			<b>Z40 Z41 Y-16I</b>	<b>(KZ41Y)</b>	
15	130	95	65	46	14	2	4-14	220	240	120
20	150	105	75	56	16	2	4-14	255	284	140
25	160	115	85	65	16	2	4-14	275	303	160
32	180	140	100	76	18	2	4-18	280	321	180
40	200	150	110	84	18	2	4-18	300	352	200
50	250	165	125	99	20	2	4-18	358	438	240
65	270	185	145	118	20	2	4-18	375	450	240
80	280	200	160	132	20	2	8-18	438	528	280
100	300	220	180	156	22	2	8-18	502	620	320
125	325	250	210	184	22	2	8-18	612	753	360
150	350	285	240	211	24	2	8-23	676	847	360
200	400	340	295	266	24	2	12-22	820	1039	400
250	450	405	355	319	26	2	12-26	969	1245	450
300	500	460	410	370	28	2	12-26	1142	1472	560
350	550	520	470	429	30	2	16-26	1280	1450	640
400	600	580	525	480	32	2	16-30	1452	1887	640
450	650	640	585	548	40	2	20-30	1541	2011	720
500	700	715	650	609	44	2	20-33	1676	2181	720
600	800	840	770	720	48	2	20-36	1874	2346	800
	<b>Z40H Z41Y -25</b>	<b>Z40 Z41 Y-25P</b>	<b>Z40 Z41 Y-25R</b>	<b>Z40 Z41 W-25P</b>	<b>Z40 Z41 W-25R</b>			<b>Z40 Z41 Y-25I</b>	<b>(KZ41Y)</b>	
15	130	95	65	46	14	2	4-14	220	240	120
20	150	105	75	56	16	2	4-14	255	284	140
25	160	115	85	65	16	2	4-14	275	303	160
32	180	140	100	76	18	2	4-18	280	321	180
40	200	150	110	84	18	2	4-18	300	352	200
50	250	165	125	99	20	2	4-18	358	438	240
65	270	185	145	118	22	2	8-18	375	450	240
80	280	200	160	132	24	2	8-18	433	528	280
100	300	235	190	156	24	2	8-22	502	620	320
125	325	270	220	184	26	2	8-26	612	753	360
150	350	300	250	211	28	2	8-26	676	847	360
200	400	360	310	274	30	2	12-26	820	1039	400
250	450	425	370	330	32	2	12-30	696	1245	450
300	500	485	430	389	34	2	16-30	1142	1472	560
350	550	555	490	448	38	2	16-33	1280	1450	640
400	600	620	550	503	40	2	16-36	1452	1887	640
450	650	670	600	548	46	2	20-36	1541	2011	720
500	700	730	660	609	48	2	20-36	1676	2181	720
600	800	845	770	720	48	2	20-39	1874	2346	800



# China Standard Gate Valve

● Z40/Z41/KZ41

The main dimensions

unit:mm

DN	L	D	D1	D2	D6	b	f	f2	Z-d	H	H1	Do
Z40H Z41Y -40		Z40 Z41 Y-40P		Z40 Z41 Y-40R		Z40 Z41 W-40P		Z40 Z41 W-40R		Z40 Z41 Y-40I		(KZ41Y)
20	150	105	75	56	51	16	2	4	4-14	256	285	140
25	160	115	85	65	58	16	2	4	4-14	275	305	160
32	180	140	100	76	66	18	2	4	4-18	287	322	180
40	200	150	110	84	76	18	3	4	4-18	323	369	200
50	250	165	125	99	88	20	3	4	4-18	372	440	280
65	280	185	145	118	110	22	3	4	8-18	395	473	280
80	310	200	160	132	121	24	3	4	8-18	457	552	320
100	350	235	190	156	150	24	3	4.5	8-22	552	671	360
125	400	270	220	184	176	26	3	4.5	8-26	634	726	400
150	450	300	250	211	204	28	3	4.5	8-26	708	883	400
200	550	375	320	284	260	34	3	4.5	12-30	858	1086	450
250	650	450	385	345	313	38	3	4.5	12-33	1015	1298	560
300	750	515	450	409	364	42	4	4.5	16-33	1203	1535	640
350	850	580	510	465	422	46	4	5	16-36	1341	1678	640
400	950	660	585	535	474	50	4	5	16-39	1492	1903	720
Z40H Z41Y -64		Z40 Z41 Y-64P		Z40 Z41 Y-64R		Z40 Z41 W-64P		Z40 Z41 W-64R		Z40 Z41 Y-64I		(KZ41Y)
20	190	130	90	56	51	20	2	4	4-18	258	288	180
25	210	140	100	65	58	24	2	4	4-18	310	341	200
32	230	155	110	76	66	24	2	4	4-22	320	353	200
40	240	170	125	84	76	26	2	4	4-22	360	389	240
50	250	180	135	99	88	26	2	4	4-22	372	448	280
65	280	205	160	118	110	26	2	4	8-22	395	475	280
80	310	215	170	132	121	28	2	4	8-22	458	553	320
100	350	250	200	156	150	30	2	4.5	8-26	553	679	360
125	400	295	240	184	176	34	2	4.5	8-30	638	779	400
150	450	345	280	211	204	36	2	4.5	8-33	718	893	450
200	550	415	345	284	260	42	2	4.5	12-36	873	1100	560
250	650	470	400	345	313	46	2	4.5	12-36	1053	1332	640
300	750	530	460	409	364	52	2	4.5	16-36	1203	1535	640
Z40H Z41Y -100		Z40 Z41 Y-100P		Z40 Z41 Y-100R		Z40 Z41 W-100P		Z40 Z41 W-100R		Z40 Z41 Y-100I		(KZ41Y)
25	210	140	100	65	58	24	2	4	4-18	310	341	200
32	230	155	110	76	66	24	2	4	4-22	320	353	240
40	240	170	125	84	76	26	2	4	4-22	360	389	280
50	250	195	145	99	88	28	2	4	4-26	490	558	360
65	280	220	170	118	110	30	2	4	8-26	540	622	400
80	310	230	180	132	121	32	2	4	8-26	573	671	400
100	350	265	210	156	150	36	2	4.5	8-30	575	671	400
125	400	315	250	184	176	40	2	4.5	8-33	744	892	560
150	450	355	290	211	204	44	2	4.5	12-33	800	972	560
200	550	430	360	284	260	52	2	4.5	12-36	800	972	560
250	650	505	430	345	313	60	2	4.5	12-39	1050	1305	640
300	750	585	500	409	364	68	2	4.5	16-42	1208	1506	640
Z40H Z41Y -160		Z40 Z41 Y-160P		Z40 Z41 Y-160R		Z40 Z41 W-160P		Z40 Z41 W-160R		Z40 Z41 Y-160I		(KZ41Y)
15	170	105	75	46	40	26	2	4	4-14	230	250	200
20	190	130	90	56	51	30	2	4	4-18	260	288	200
25	210	140	100	65	58	32	2	4	4-18	280	310	280
32	230	155	110	76	66	34	2	4	4-22	312	350	320
40	240	170	125	84	76	36	2	4	4-22	350	395	320
50	300	195	145	99	88	38	2	4	8-26	512	612	360
65	340	220	170	118	110	42	2	4	8-26	260	677	360
80	390	230	180	132	121	46	2	4	8-26	585	686	400
100	450	265	210	156	150	52	2	4.5	8-30	631	751	450
125	525	315	250	184	176	56	2	4.5	8-33	723	868	560
150	600	355	290	211	204	62	2	4.5	12-33	820	997	640
200	750	430	360	284	250	66	2	4.5	12-36	990	1224	720

Gate valve series



# Electric Actuator Gate Valve

● Z940/Z941

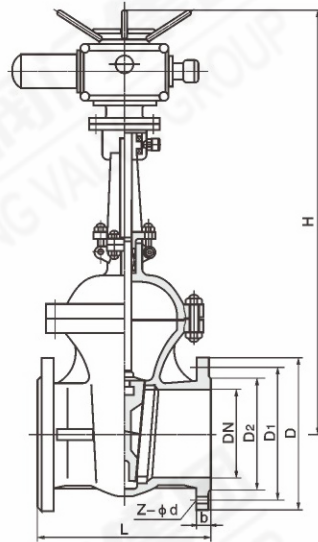

## The main dimensions

unit:mm

DN	L	D	D1	D2	b	f	Z-d	H	Electric device
	Z940H Z941Y -16C	Z940 Z941 Y-16P	Z940 Z941 Y-16R	Z940 Z941 W-16P	Z940 Z941 W-16R	Z940 Z941 Y-16I			
40	200	150	110	84	18	2	4-18	595	DZW15
50	250	165	125	99	20	2	4-18	653	DZW20
65	270	185	145	118	20	2	4-18	665	DZW20
80	280	200	160	132	20	2	8-18	725	DZW20
100	300	220	180	156	22	2	8-18	787	DZW20
150	350	285	240	211	24	2	8-22	955	DZW30
200	400	340	295	266	24	2	12-22	1105	DZW30
250	450	405	355	319	26	2	12-26	1343	DZW45
300	500	460	410	370	28	2	12-26	1516	DZW60
350	550	520	470	729	30	2	16-26	1678	DZW60
400	600	580	525	480	32	2	16-30	1849	DZW90
450	650	640	585	548	40	2	20-30	1937	DZW90
500	700	715	650	609	44	2	20-33	2234	DZW120
600	800	840	770	720	48	2	20-36	3432	DZW180
700	900	910	840	794	50	5	24-36	2489	DZW250
800	1000	1025	950	901	52	5	24-39	2643	DZW350

注：DN700, DN800的型号为Z942型。

# China Standard Gate Valve

● Z940/941-PN16~160

## The main dimensions

unit:mm

DN	L	D	D1	D2	D6	b	Z-d	f	f2	H	Electric device
Z940H Z941Y -25C		Z940 Z941 Y-25P		Z940 Z941 Y-25R		Z940 Z941 W-25P		Z940 Z941 W-25R		Z940 Z941 Y-25I	
40	200	150	110	84	-	18	4-18	2	-	595	DZW15
50	250	165	125	99	-	20	4-18	2	-	653	DZW20
65	265	185	145	118	-	22	8-18	2	-	665	DZW20
80	280	200	160	132	-	24	8-18	2	-	725	DZW20
100	300	230	190	156	-	24	8-22	2	-	787	DZW20
125	325	270	220	184	-	26	8-26	2	-	902	DZW30
150	350	300	250	211	-	28	8-26	2	-	955	DZW30
200	400	360	310	274	-	30	12-26	2	-	1105	DZW45
250	425	425	370	330	-	32	12-30	2	-	1343	DZW45
300	450	485	430	389	-	34	16-30	2	-	1516	DZW60
350	550	555	490	448	-	38	16-33	2	-	1678	DZW60
400	600	620	550	503	-	40	16-36	2	-	1849	DZW90
450	650	670	600	548	-	46	16-36	2	-	1937	DZW90
500	700	730	660	609	-	48	20-36	2	-	2234	DZW120
600	800	845	770	720	-	48	20-39	2	-	2432	DZW180
700	900	960	875	820	-	50	24-42	5	-	2489	DZW250
800	1000	1085	990	928	-	54	24-48	5	-	2643	DZW350
Z940H Z941Y -40		Z940 Z941 Y-40P		Z940 Z941 Y-40R		Z940 Z941 W-40P		Z940 Z941 W-40R		Z940 Z941 Y-40I	
40	200	150	110	84	76	18	4-18	2	4	617	DZW15
50	250	165	125	99	88	20	4-18	2	4	665	DZW20
65	280	185	145	118	110	22	8-18	2	4	680	DZW20
80	310	200	160	132	121	24	8-18	2	4	752	DZW20
100	350	235	190	156	150	24	8-23	2	4.5	846	DZW30
150	450	300	250	211	204	28	8-25	2	4.5	1087	DZW45
200	550	375	320	284	260	34	12-30	2	4.5	1243	DZW45
250	650	450	385	345	313	38	12-34	2	4.5	1429	DZW60
300	750	515	450	409	364	42	16-34	2	4.5	1608	DZW90
350	850	570	510	465	422	46	16-34	2	5	1738	DZW90
400	950	660	585	535	474	50	16-41	2	5	1897	DZW120
450	1050	685	610	560	524	57	20-41	2	5	2104	DZW180
500	1150	755	670	615	576	57	20-48	2	5	2401	DZW180

注：DN700, DN800的型号为Z942型。



# Electric Actuator Gate Valve

● Z940/941-PN16~160

## The main dimensions

unit:mm

DN	L	D	D1	D2	D6	b	Z-d	f	f2	H	Electric device
<b>Z940H Z941Y -64</b>		<b>Z940 Z941 Y-64P</b>		<b>Z940 Z941 Y-64R</b>		<b>Z940 Z941 W-64P</b>		<b>Z940 Z941 W-64R</b>		<b>Z940 Z941 Y-64I</b>	
40	250	180	135	99	88	26	4-22	2	4	667	DZW20
50	280	205	160	118	110	26	8-22	2	4	685	DZW20
65	310	215	170	132	121	28	8-22	2	4	748	DZW30
80	350	250	200	156	150	30	8-26	2	4.5	845	DZW30
100	450	345	280	211	204	36	8-33	2	4.5	1009	DZW45
150	550	415	345	284	260	44	12-36	2	4.5	1253	DZW60
200	650	470	400	345	313	46	12-36	2	4.5	1449	DZW60
250	750	530	460	409	361	52	16-36	2	4.5	1867	DZW90
300	850	600	525	465	422	56	16-39	2	5	1931	DZW120
350	950	670	585	535	474	60	16-42	2	5	2017	DZW180
400	1150	800	705	640	576	70	20-54	2	5	2459	DZW250
<b>Z940H Z941Y -100</b>		<b>Z940 Z941 Y-100P</b>		<b>Z940 Z941 Y-100R</b>		<b>Z940 Z941 W-100P</b>		<b>Z940 Z941 W-100R</b>		<b>Z940 Z941 Y-100I</b>	
40	250	195	145	112	88	28	4-25	3	4	781	DZW20
50	280	200	170	138	110	32	8-25	3	4	830	DZW20
65	310	230	180	148	121	34	8-25	3	4	865	DZW30
80	350	265	210	172	150	38	8-30	3	4.5	1179	DZW30
100	450	350	290	250	204	46	12-34	3	4.5	1201	DZW60
150	550	430	360	312	260	54	12-41	3	4.5	1611	DZW90
200	650	500	430	382	313	60	12-41	3	4.5	1903	DZW90
250	750	585	500	442	364	70	16-48	4	4.5	2054	DZW120
300	850	655	560	498	422	76	16-54	4	5	2132	DZW180
350	950	715	620	558	474	80	16-54	4	5	2321	DZW250
<b>Z940H Z941Y -160</b>		<b>Z940 Z941 Y-160P</b>		<b>Z940 Z941 Y-160R</b>		<b>Z940 Z941 W-160P</b>		<b>Z940 Z941 W-160R</b>		<b>Z940 Z941 Y-160I</b>	
40	300	215	165	132	88	36	8-25	3	4	905	DZW20
50	340	245	190	152	110	44	8-30	3	4	968	DZW20
65	390	260	205	168	121	46	8-30	3	4	978	DZW30
80	450	300	240	200	150	48	8-34	3	4.5	1043	DZW30
100	525	355	285	238	176	60	8-41	3	4.5	1248	DZW60
150	600	390	318	270	204	66	12-41	3	4.5	1394	DZW90
200	750	480	400	345	250	78	12-48	3	4.5	1621	DZW120

注：根据用户需要可提供气动和齿轮传动闸阀产品。

# Pneumatic Actuator Gate Valve

● CZ6s40H-16~40C/P/R

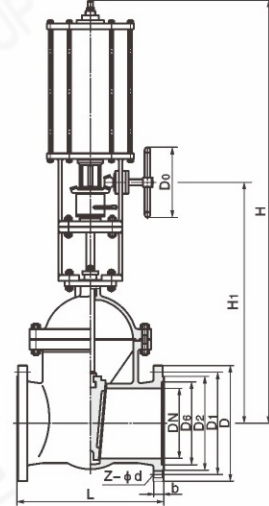
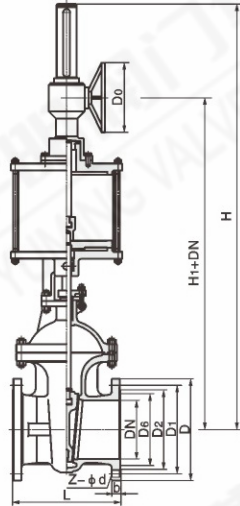

The main dimensions

unit:mm

DN	L	D	D1	D2	b	Z-d	H	H1	D0
			CZ6s40H-16C		CZ6s40Y-16P		CZs40Y-16R		
50	250	165	125	99	20	4-Φ18	950	570	180
65	270	185	145	118	20	4-Φ18	1050	596	180
80	280	200	160	132	20	8-Φ18	1080	635	200
100	300	220	180	156	22	8-Φ18	1145	645	250
125	325	250	210	184	22	8-Φ18	1210	685	250
150	350	285	240	211	24	8-Φ22	1300	720	320
200	400	340	295	266	24	12-Φ22	1660	940	400
250	450	405	355	319	26	12-Φ26	1790	1020	400
300	500	460	410	370	25	12-Φ26	1990	1150	450
350	550	520	470	429	30	16-Φ26	2090	1170	450
400	600	580	525	480	32	16-Φ30	2290	1325	500
450	650	640	585	548	40	20-Φ30	2485	1465	500
500	700	715	650	609	44	20-Φ33	2640	1590	550
600	800	840	770	720	48	20-Φ36	2940	1720	550
700	900	910	840	794	50	24-Φ36	3450	1960	600
800	1000	1025	950	901	52	24-Φ39	3650	2190	600
900	1100	1125	1050	1001	54	28-Φ39	3815	2400	800
1000	1200	1255	1170	1112	56	28-Φ42	4000	2650	800



# Pneumatic Actuator Gate Valve

● CZ6s40H-16~40C/P/R

## The main dimensions

unit:mm

DN	L	D	D1	D2	b	Z-d	H	H1	D0
			CZ6s40H-25		CZ6s40H-25P	CZ6s40Y-25R			
50	250	165	125	99	20	4-18	950	570	180
65	270	185	145	118	22	8-18	1050	596	180
80	280	200	160	132	24	8-18	1080	635	200
100	300	235	190	156	24	8-22	1145	645	250
125	325	270	220	184	26	8-26	1210	685	250
150	350	300	250	211	28	8-26	1300	720	320
200	400	360	320	274	30	12-26	1660	940	400
250	450	425	370	330	32	12-30	1790	1020	400
300	500	485	430	389	34	16-30	1990	1150	450
350	550	555	490	448	38	16-33	2090	1170	450
400	600	620	550	503	40	16-36	2290	1325	500
450	650	670	600	548	46	20-36	2485	1465	500
500	700	730	660	609	48	20-36	2640	1590	550
600	800	845	770	720	48	20-39	2940	1720	550
700	900	960	875	820	50	21-42	3450	1960	600
800	1000	1085	990	928	54	24-48	3650	2190	600
900	1100	1185	1090	1028	58	28-48	3815	2400	800
1000	1200	1320	1210	1140	62	28-55	4000	2650	800

Gate valve series

## The main dimensions

unit:mm

DN	L	D	D1	D2	D6	b	Z-Φd	H	H1	D0
			CZ6s40H-40		CZ6s40Y-40P	CZ6s40Y-40R				
50	250	165	125	99	88	20	4-18	950	570	200
65	280	185	145	118	110	22	8-18	1050	596	200
80	320	200	160	132	121	24	8-18	1080	635	250
100	350	235	190	156	150	24	8-22	1145	645	320
125	400	270	220	184	176	26	8-26	1210	700	320
150	450	300	250	211	204	28	8-26	1330	750	400
200	550	375	320	284	260	34	12-30	1660	940	400
250	650	450	385	345	313	38	12-33	1820	1050	450
300	750	515	450	409	364	42	16-33	1990	1150	450
350	850	580	510	465	422	46	16-36	2110	1190	500
400	950	660	585	535	474	50	16-39	2335	1370	550
450	1050	685	610	560	524	57	20-39	2490	1510	550
500	1150	755	670	615	576	57	20-42	2640	1590	550
600	1350	890	795	735	678	62	20-48	2940	1720	600

# American Standard Gate Valve

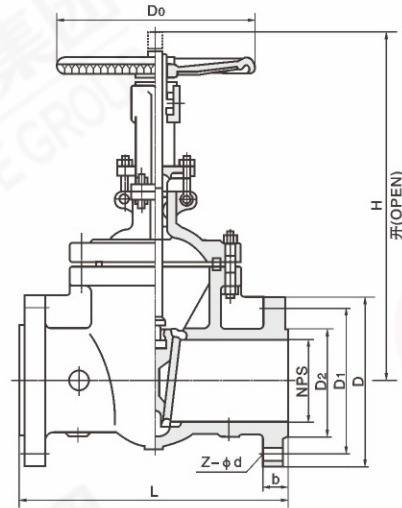

## Product performance standards

Design and Manufacturing	Structure length	Flange size	Butt welding connection size	Pressure ~ temp	Test
API 60	ANSI B16.10	ANSI B16.5	ANSI B16.25	ANSI B16.34	API 598

## Product performance specifications

Nominal pressure (LB)	Strength test		Water seal test		Air seal test	
	MPa	Lbf/in <sup>2</sup>	MPa	Lbf/in <sup>2</sup>	MPa	Lbf/in <sup>2</sup>
150	3.1	450	2.2	315	0.5~0.7	60~100
300	7.8	1125	5.6	815		
600	15.3	2225	11.2	1630		
900	23.1	3350	16.8	2440		
1500	38.4	5575	28.1	4080		
2500	64.6	9367	47.4	6873		

## Main parts materials

body/bonnet/disc	stem	seal	gasket	packing	Operating temperature(°C)	Suitable medium	
WCB	20Cr13	13Cr STL Body material PTFE nylon	Reinforced graphite 13Cr/graphite 1SF8-2 08 Soft steel F304 F316 F304L F316L	graphite Reinforced graphite SFB/260 SFB/260 PTFE	≤425	water/steam/oil	
WC1	38CrMoAl 25Cr2Mov				≤450		
WC6					≤540		
WC9					≤570		
C5 C12					≤540		
CF8					F304		≤600
CF3					F316		
CF8M					F304L		
CF3M					F316L		



# American Standard Gate Valve

● Class-150Lb~600Lb

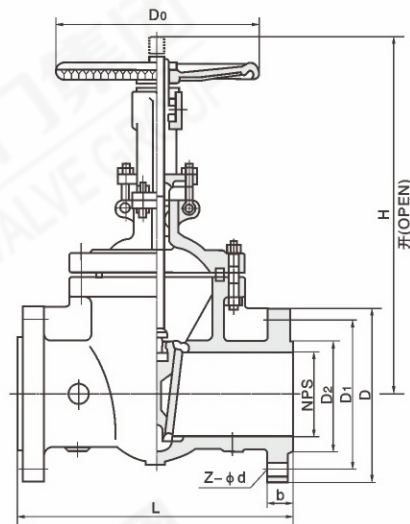

The main dimensions

unit:mm

in	DN	unit	L	H	D	D1	D2	b	Z-Φd	D0
<b>Class 150</b>										
2	50	in	7.00	16.10	6.00	4.75	3.62	0.75	4-0.75	8.00
		mm	178	409	152	120.5	92	19.1	4-19	200
3	80	in	8.00	20.00	7.50	6.00	5.00	0.94	4-0.75	10.00
		mm	203	570	90	152.5	127	23.9	4-19	250
4	100	in	9.00	23.20	9.00	7.50	6.19	0.94	8-0.75	10.00
		mm	229	590	229	190.5	157	23.9	8-19	250
6	150	in	10.50	24.80	11.00	9.50	8.50	1.00	8-0.88	12.00
		mm	267	630	279	241.5	216	25.4	8-22	300
8	200	in	11.50	37.80	13.50	11.75	10.62	1.25	8-0.88	3.88
		mm	292	960	343	298.5	270	28.5	8-22	350
10	250	in	13.00	45.60	16.00	14.25	12.75	1.19	12-1.00	15.70
		mm	330	1158	406	362	324	30.2	12-25	400
12	300	in	14.00	54.30	19.00	17.00	15.00	1.25	12-1.00	17.70
		mm	356	1378	483	432	381	31.8	12-25	450
14	350	in	15.00	60.75	21.00	18.75	16.25	1.38	12-1.12	19.70
		mm	381	1543	533	476.5	413	35	12-29	50
16	400	in	16.00	68.40	23.50	21.25	18.50	1.44	16-1.12	23.6
		mm	406	1738	597	539.5	470	36.6	16-29	600
18	450	in	17.00	74.10	25.00	22.75	21.00	1.56	16-1.25	23.60
		mm	432	1959	635	578	533	39.7	16-32	600
20	500	in	18.00	87.20	27.50	25.00	23.00	1.69	20-1.25	26.80
		mm	457	2214	698	635	584	42.9	20-32	680
24	600	in	20.00	102.3	32.00	29.50	27.25	1.88	20-1.38	29.90
		mm	508	2599	813	749.5	692	47.7	20-35	760
30	750	in	24.00	125.3	38.75	36.00	33.75	2.94	28-1.38	36.00
		mm	610	3183	985	914	857	74.5	28-35	915
36	900	in	28.00	147.00	46.00	42.75	40.25	3.56	32-1.62	36.00
		mm	711	3737	1170	1086	1022	90.5	32.41	915

# American Standard Gate Valve

## The main dimensions

unit:mm

in	DN	unit	L	H	D	D1	D2	b	Z-Φd	D0
<b>Class 300</b>										
2	50	in	8.50	16.70	6.5	5.00	3.62	0.88	8-0.75	8.0
		mm	216	424	165	127	92	22.3	8-19	200
3	80	in	11.15	21.00	8.25	6.62	5.00	1.12	8-0.88	10
		mm	283	535	210	168	127	28.5	8-22	250
4	100	in	12.00	24.20	10.0	7.88	6.19	1.25	8-0.88	10
		mm	305	615	254	200	157	31.8	8-22	250
6	150	in	15.87	31.30	12.50	10.62	8.5	1.44	8-0.88	14
		mm	4.3	795	318	270	216	36.6	12-22	350
8	200	in	16.50	39.90	15.0	13.0	10.62	1.62	12-1.0	15.4
		mm	419	1012	381	330	270	41.3	12-25	400
10	250	in	18.00	48.540	17.50	15.25	12.75	1.88	16-1.12	17.7
		mm	457	1231	444	387.5	324	47.7	16-29	450
12	300	in	19.75	57.0	20.50	17.75	15.00	2.00	16-1.25	19.7
		mm	502	1450	521	451	381	50.8	16-32	500
14	350	in	30.00	64.8	23.00	20.25	16.25	2.12	20-1.25	23.6
		mm	762	1645	584	514.5	413	54.0	20-32	600
16	400	in	33.00	72.50	25.50	20.25	18.50	2.28	20-1.38	23.6
		mm	838	1814	648	571.5	470	57.2	20-35	600
18	450	in	36.00	76.50	28.00	24.75	21.00	2.38	24-1.38	26.8
		mm	914	1943	711	628.5	533	60.4	24-35	680
20	500	in	39.00	84.80	30.50	27.0	23.0	2.80	24-1.38	38
		mm	991	2154	775	686	584	63.5	24-35	760
24	600	in	45.00	100.50	36.0	32.0	27.25	2.75	24-1.62	36
		mm	1143	2553	914	813	692	69.9	24-41	915
<b>Class 600</b>										
2	50	in	11.50	18	6.5	5.00	3.62	1.0	8-0.75	10
		mm	292	458	165	127	92	25.4	8-19	250
3	80	in	14.00	22.50	8.25	6.62	5.00	1.25	8-0.88	10
		mm	356	570	210	168	127	31.8	8-22	250
4	100	in	17.00	27.2	10.75	8.50	6.19	1.5	8-1.0	14
		mm	432	390	273	216	157	38.1	8-25	350
6	150	in	22	35.8	14	11.50	8.50	1.88	12-1.12	18
		mm	559	910	356	292	216	47.7	12-29	450
8	200	in	26.00	41.9	16.5	13.75	10.62	2.19	12-1.25	19.7
		mm	600	1064	419	349	270	55.6	12-32	500
10	250	in	31.00	49.5	20	17.00	12.75	2.5	16-1.38	23.6
		mm	787	1257	508	432	324	63.5	16-35	600
12	300	in	33	57.8	22	19.25	15.00	2.62	20-1.38	26.8
		mm	838	1468	559	489	381	66.7	20-35	680
14	350	in	35	63.9	23.75	20.75	16.28	2.75	20-1.50	26.9
		mm	889	1623	603	527	413	69.9	20-38	760
16	400	in	39	71.5	27	23.75	18.50	3.0	20-1.62	26.9
		mm	991	1816	686	603	470	76.2	20-41	760
18	450	in	43	82.7	29.25	25.75	21.00	3.25	20-10.75	36
		mm	1092	2100	743	654	533	82.6	20-45	915
20	500	in	47	88.6	32	28.5	23.00	3.5	24-1.75	37.4
		mm	1194	2250	813	724	584	88.9	24-45	950
24	600	in	55	107.5	37	33.0	27.25	4.0	24-2.0	39.4
		mm	1397	2730	940	838	692	102	24-51	1000

Gate valve series



# Forged steel Gate Valve

● Z41Y-16~25, 40

## Performance specification

- 1.Design and Manufacturing: JB/T7746
- 2.Structure length: GB/T1221
- 3.Flange end size: JB/T82.1RF82.2FM82.4RJ
- 4.Inspection and Test: JB/T9092 and GB/T26480
- 5.Body material: A105/LF2/F5/F11/F22/F91/F304F/F316F/F304L/F316L/F347/F310S/F51

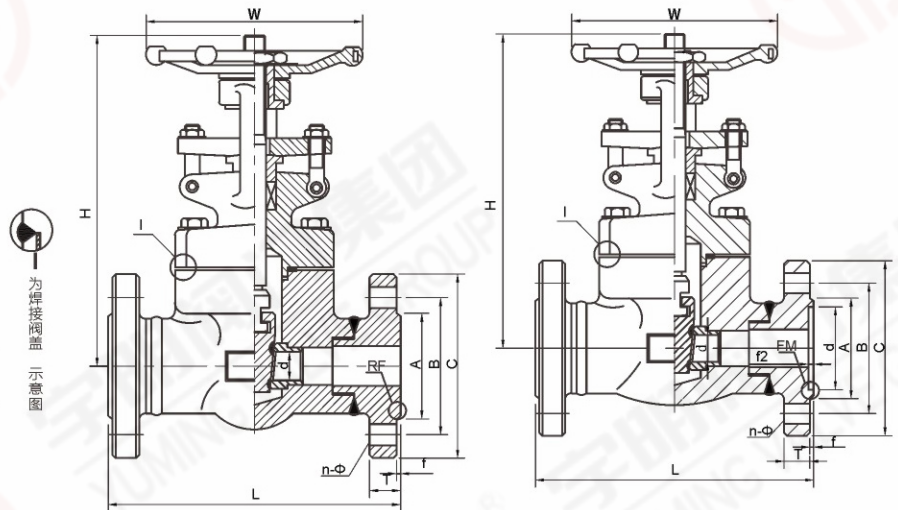

Gate valve series

## The main dimensions

unit:mm

DN	d	L	H	W	A	B	C	d	f	f2	T	N-Φ
PN16~PN25												
15	10.5	130	155	100	45	65	95	-	2	-	16	4-14
20	13	150	157	100	55	75	105	-	2	-	16	4-14
25	17.5	160	186	125	65	85	115	-	2	-	16	4-14
32	23.5	180	220	160	75	100	135	-	2	-	18	4-18
40	28	200	246	160	85	110	145	-	2	-	18	4-18
50	36	250	268	180	100	125	160	-	2	-	20	4-18
PN40												
15	10.5	130	155	100	45	65	95	40	2	4	16	4-14
20	13	150	157	100	55	75	105	51	2	4	16	4-14
25	17.5	160	186	125	65	85	115	58	2	4	16	4-14
32	24	180	220	160	75	100	135	66	2	4	18	4-18
40	29	200	246	160	85	110	145	76	2	4	18	4-18
50	36.5	250	268	180	100	125	160	88	2	4	20	4-18

# Forged steel Gate Valve

● Z41Y-63, 100, 160, 250

## The main dimensions

unit:mm

DN	d	L	H	W	A	B	C	d	f	f2	T	N-Φ
<b>PN63</b>												
15	10.5	170	161	100	55	75	105	40	2	4	20	4-14
20	13	190	163	100	68	90	125	51	2	4	22	4-18
25	17.5	210	200	125	78	100	135	58	2	4	24	4-18
32	24	230	220	160	82	110	150	66	2	4	24	4-23
40	29	240	252	160	95	125	165	76	3	4	26	4-23
50	36.5	250	290	180	105	135	175	88	3	4	28	4-23
<b>PN100</b>												
15	10.5	170	161	100	55	75	105	40	2	4	20	4-14
20	13	190	163	100	68	90	130	51	2	4	22	4-18
25	17.5	210	200	125	78	100	135	58	2	4	24	4-18
32	24	230	220	160	82	110	150	66	2	4	26	4-23
40	29	240	252	160	95	125	165	76	3	4	28	4-23
50	36.5	250	290	180	112	145	195	88	3	4	30	4-25
<b>PN160</b>												
15	10.5	170	161	100	55	75	105	40	2	4	20	4-14
20	13	190	163	100	68	90	130	51	2	4	22	4-18
25	17.5	210	200	125	78	100	135	58	2	4	24	4-18
32	24	230	220	160	82	110	150	66	2	4	26	4-23
40	29	240	252	160	95	125	165	76	3	4	28	4-23
50	36.5	250	290	180	112	145	195	88	3	4	30	4-25
<b>PN250</b>												
15	10.5	170	163	100	70	90	130	40	2	4	26	4-18
20	13	190	200	125	75	95	135	51	2	4	28	4-18
25	17.5	210	220	160	82	105	150	58	2	4	28	4-22
32	24	230	252	160	96	120	165	66	2	4	32	4-22



# Forged steel Gate Valve

● Z41Y-800Lb, 1500Lb, 2500Lb ● Z41Y-140, 250

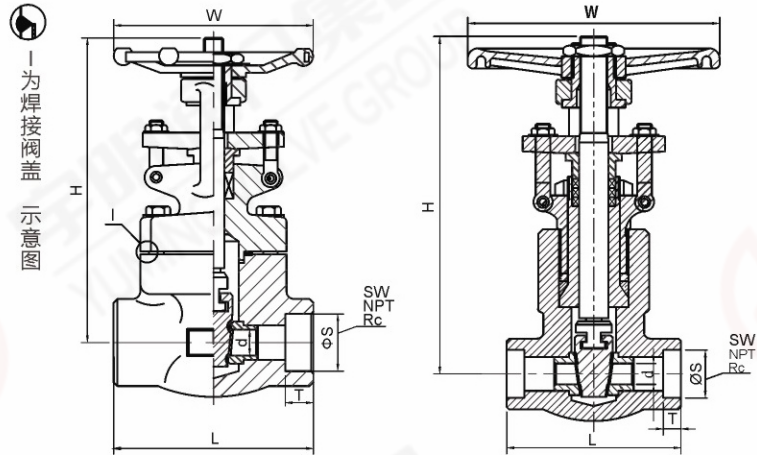

## The main dimensions

unit:mm

NPS	d	L	H	W	ΦS	T
<b>Class:800Lb PN140</b>						
1/2"	10.5	79	158	100	端口尺寸 SW NPT RC	
3/4"	13	92	160	100		
1"	18	111	197	125		
1 1/4"	24	120	228	160		
1 1/2"	29	120	246	160		
2"	36.5	140	290	180		
<b>Class:1500Lb PN250</b>						
1/2"	10.5	111	200	125	端口尺寸 SW NPT RC	
3/4"	13	111	200	125		
1"	17.5	120	220	160		
1 1/4"	24	120	255	160		
1 1/2"	29	140	290	180		
2"	36.5	178	316	200		
<b>Class:2500Lb</b>						
1/2"	10.5	186	345	250	端口尺寸 SW NPT RC	
3/4"	13	186	345	250		
1"	17.5	186	345	250		
1 1/4"	24	228	460	280		
1 1/2"	29	228	460	280		
2"	36.5	276	520	280		

## The main dimensions

unit:mm

DN	d	L	H	W	d	B	C	d	f	f2	T	n-Φ
<b>PN250</b>												
15	10.5	170	163	100	70	90	130	40	2	4	26	4-18
20	13	190	200	125	75	95	135	51	2	4	28	4-18
25	17.5	210	220	160	82	105	150	58	2	4	28	4-22
32	24	230	252	160	96	120	165	66	2	4	32	4-22
40	29	260	290	180	108	135	185	76	3	4	34	4-26
50	36.5	300	345	200	122	150	200	88	3	4	38	4-26

# American Standard Globe Valve

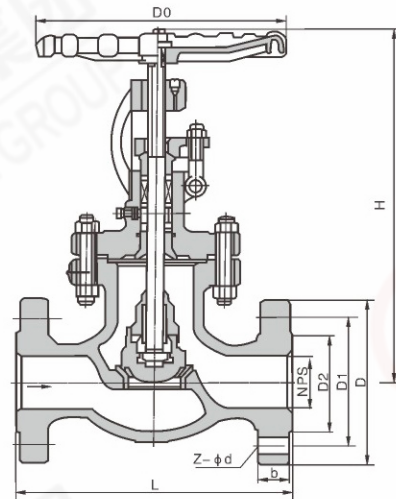

## Executive standard

Design and Manufacturing	Structure length	Flange size	Butt welding connection size	Pressure temp	Test
ANSI B16.34, BS1873	ANSI B16.10	ANSI B16.5	ANSI B16.25	ANSI B16.34	API 598

## Performance specifications

Nominal pressure (LB)	Strength test		Water seal test		Air seal test	
	MPa	Lbf/in <sup>2</sup>	MPa	Lbf/in <sup>2</sup>	MPa	Lbf/in <sup>2</sup>
150	3.1	450	2.2	315	0.5~0.7	60~100
300	7.8	1125	5.6	815		
600	15.3	2258	11.2	1630		
900	23.1	3350	16.8	2440		
1500	38.4	5575	28.1	4080		
2500	64.6	9367	47.4	6873		

## Main part material

body/bonnet/disc	stem	seal	gasket	packing	Operating temp	Suitable medium
WCB	Cr13	13Cr STL Body material PTFE nylon	Reinforced graphite 13Cr/graphite SFB-2 08 Soft steel F304 F316 F304L F316L	graphite Reinforced graphite SFB/260 PTFE	-29~425	water/steam/oil
WC1	38CrMoAl 25Cr2Mov				≤450	
WC6					≤540	
WC9					≤570	
C5C12					≤540	
CF8	F304				Nitric acid acetic acid urea	≤600
CF3	F316					
CF8M	F304L					
CF3M	F316L					



# American Standard Globe Valve

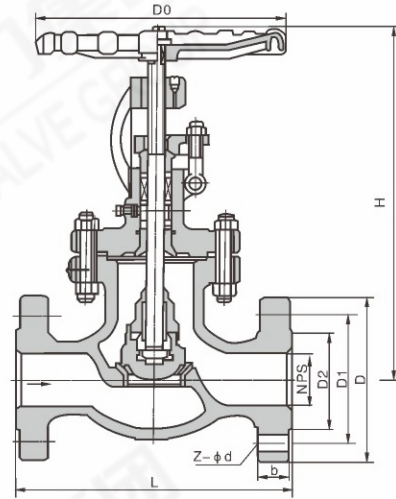

## The main dimensions

Size		L	D	D1	D2	b	n-Φd	W	H
<b>Class 150</b>									
1/2"	mm	108	90	60.5	35	12	4-15	125	169
	in	4.25	3.5	2.38	1.38	0.47	4-0.59	4.92	6.65
3/4"	mm	117	98	70	43	12	4-15	125	180
	in	4.61	3.86	2.76	1.69	0.47	4-0.59	4.92	7.08
1"	mm	127	108	79.5	51	12	4-15	125	190
	in	5	4.25	3.13	2	0.47	4-0.59	4.92	7.48
1 1/2"	mm	165	127	98.5	73	14.3	4-16	180	347
	in	6.5	5	3.88	2.87	0.56	4-0.62	7.09	13.66
2"	mm	203	152	120.5	92	15.9	4-19	180	356
	in	8.00	6.00	4.75	3.62	0.625	4-0.75	7.09	14
2 1/2"	mm	216	178	139.5	105	17.5	4-19	240	381
	in	8.5	7	5.50	4.12	0.69	4-0.75	9.45	15.00
3"	mm	241	190	152.4	127	19.1	4-19	280	13
	in	9.5	7.50	6	5	0.75	4-0.75	11.02	16.25
4"	mm	292	229	190.5	157	24	8-19	280	500
	in	11.50	9.00	7.5	6.19	0.94	8-0.75	11.02	19.68
6"	mm	406	279	241.5	216	25.4	8-22	360	656
	in	16	11.0	9.50	8.5	1.00	8-0.88	14.17	22.25
8"	mm	495	343	298.5	270	29	8-22	17.75	660
	in	19.5	13.5	11.75	10.62	1.12	8-0.88	450	26.00

# American Standard Globe Valve

## The main dimensions

Size		L	D	D1	D2	b	n-Φd	W	H
<b>Class 300</b>									
1/2"	mm	152	95	66.5	35	15	4-15	125	190
	in	5.98	3.74	2.62	1.38	0.95	4-0.59	4.92	7.84
3/4"	mm	178	117	82.5	43	16	4-19	125	212
	in	7	4.61	3.25	1.69	0.62	4-0.75	4.92	8.35
1"	mm	203	124	89	51	18	4-19	160	231
	in	8	4.9	3.50	2	0.71	4-0.75	6.2	9.1
1 1/2"	mm	229	156	114.5	73	20.7	4-22	200	391
	in	9	6.12	4.51	2.87	0.81	4-0.87	8	15.43
2"	mm	267	165	127	92	22	8-19	200	406
	in	105	6.5	5	3.62	0.88	8-0.75	7.87	16.00
2 1/2"	mm	292	190	149	105	25	8-22	240	457
	in	11.5	7.5	5.88	4.12	1.00	8-0.88	9.45	18.00
3"	mm	318	210	168.5	127	29	8-22	280	470
	in	12.50	8.25	6.62	5	1.12	8-0.88	11.02	18.50
4"	mm	356	245	200	157	32	8-22	320	590
	in	14.00	10.00	7.88	6.19	1.25	8-0.88	12.60	23.23
6"	mm	444	318	270	216	37	12-22	500	711
	in	17.50	12.50	10.62	8.5	1.44	12-0.88	19.68	28.00
8"	mm	559	381	330	270	41	12-25	500	750
	in	22.0	15	13.00	10.62	1.62	12-100	19.68	29.50

## The main dimensions

Size		L	D	D1	D2	b	n-Φd	W	H
<b>Class 600</b>									
1/2"	mm	165	95	66.5	35	15	4-15	160	285
	in	6.5	3.74	2.62	1.38	0.59	4-0.59	6.2	11.22
3/4"	mm	190	117.5	82.5	43	16	4-19	160	285
	in	7.48	4.61	3.25	1.69	0.62	4-0.75	6.2	11.22
1"	mm	216	124	89	2	18	4-19	160	313
	in	8.5	4.9	3.5	73	0.71	4-0.75	6.2	12.32
1 1/2"	mm	241	156	114.5	51	23	4-22	240	365
	in	9.5	6.12	4.51	92	0.91	4-0.88	9.45	14.17
2"	mm	292	165	127	2.87	25	8-19	240	444
	in	11.50	6.50	5.00	105	1.00	8-0.75	9.45	17.50
2 1/2"	mm	330	190	149	127	29	8-22	240	483
	in	18	7.50	5.88	5	1.12	8-0.88	9.45	19
3"	mm	358	210	168	3.62	32	8-22	280	533
	in	14.00	8.25	6.62	157	1.25	8-0.88	11.02	21
4"	mm	406	273	216	216	38.1	8-25	360	622
	in	16.00	10.75	8.5	4.12	1.5	8-1.00	14.17	24.50
6"	mm	459	356	292	8.5	47.7	12-29	500	800
	in	19.50	14	11.5	270	1.88	12-1.14	19.68	31.50
8"	mm	597	419	34.9	6.19	55.6	12-32	550	927
	in	23.50	16.5	13.75	10.62	2.19	12-1.25	21.65	36.50



# Forged steel Globe Valve

● J41Y-16~25, 40

## Performance specification

- 1.Design and Manufacturing: JB/T7746
- 2.Structure length: GB/T1221
- 3.Flange end size: JB/T82.1RF82.2FM82.4RJ
- 4.Inspection and Test: JB/T9092 and GB/T26480
- 5.Body material: A105/LF2/F5/F11/F22/F91/F304F/F316F/F304L/F316L/F347/F310S/F51

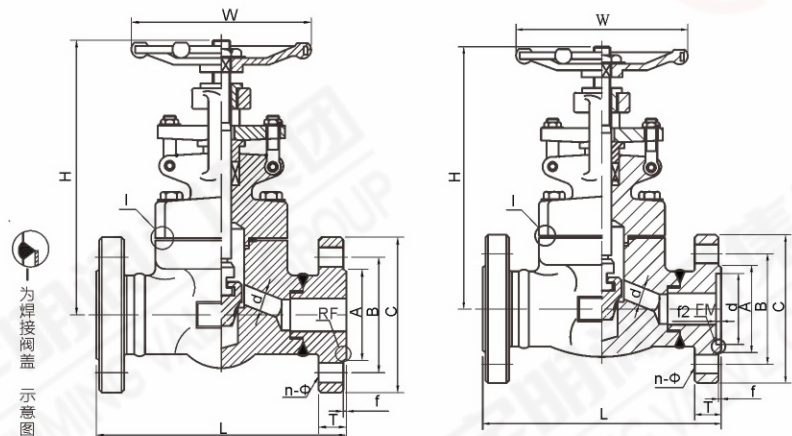

## The main dimensions

unit:mm

DN	d	L	H	W	A	B	C	f	T	N-Φ
<b>PN16~PN25</b>										
15	10.5	130	158	100	45	45	95	2	16	4-14
20	13	150	160	100	55	55	105	2	16	4-14
25	18	160	198	125	65	65	115	2	16	4-14
32	23	180	226	160	75	75	135	2	18	4-18
40	28	200	246	160	85	85	145	3	18	4-18
50	36	230	290	180	100	100	160	3	20	4-18
<b>PN40</b>										
15	10.5	130	158	100	45	65	95	2	16	4-14
20	13	150	160	100	55	75	105	2	16	4-14
25	18	160	198	125	65	85	115	2	16	4-14
32	24	180	226	160	75	100	135	2	18	4-18
40	29	200	246	160	85	110	145	3	18	4-18
50	36.5	230	290	180	100	125	160	3	20	4-18

# Forged steel Globe Valve

● J41Y-63, 100, 160, 250

## The main dimensions

unit:mm

DN	d	L	H	W	A	B	C	d	f	f2	T	N-Φ
----	---	---	---	---	---	---	---	---	---	----	---	-----

### PN63

15	10.5	170	170	100	55	75	105	40	2	4	20	4-14
20	13	190	172	100	68	90	125	51	2	4	22	4-18
25	18	210	206	125	78	100	135	58	2	4	24	4-18
32	24	230	230	160	82	110	150	66	2	4	24	4-23
40	29	260	262	160	95	125	165	76	3	4	26	4-23
50	36.5	300	295	180	105	135	175	88	3	4	28	4-23

### PN100

15	10.5	170	170	100	55	75	105	40	2	4	20	4-14
20	13	190	172	100	68	90	125	51	2	4	22	4-18
25	18	210	206	125	78	100	135	58	2	4	24	4-18
32	24	230	230	160	82	110	150	66	2	4	24	4-23
40	29	260	262	160	95	125	165	76	3	4	26	4-23
50	36.5	300	295	180	105	145	195	88	3	4	28	4-25

### PN160

15	10.5	170	172	100	55	75	110	40	2	4	24	4-18
20	13	190	206	125	62	90	130	51	2	4	26	4-23
25	18	210	230	160	72	100	140	58	2	4	28	4-23
32	24	230	262	160	85	115	165	66	2	4	30	4-25
40	29	260	295	180	92	125	175	76	3	4	32	4-27
50	36.5	300	345	200	132	165	215	88	3	4	36	8-25

### PN250

15	10.5	170	172	100	70	90	130	40	2	4	26	4-18
20	13	190	206	125	75	95	135	51	2	4	28	4-18
25	18	210	230	160	82	105	150	58	2	4	28	4-22
32	24	230	262	160	96	120	165	66	2	4	32	4-22
40	29	260	295	180	108	135	185	76	3	4	34	4-26
50	36.5	300	345	200	122	150	200	88	3	4	38	8-26



# Forged steel Globe Valve

- Z41Y-800Lb, 1500Lb, 2500Lb
- Z41Y-140, 250

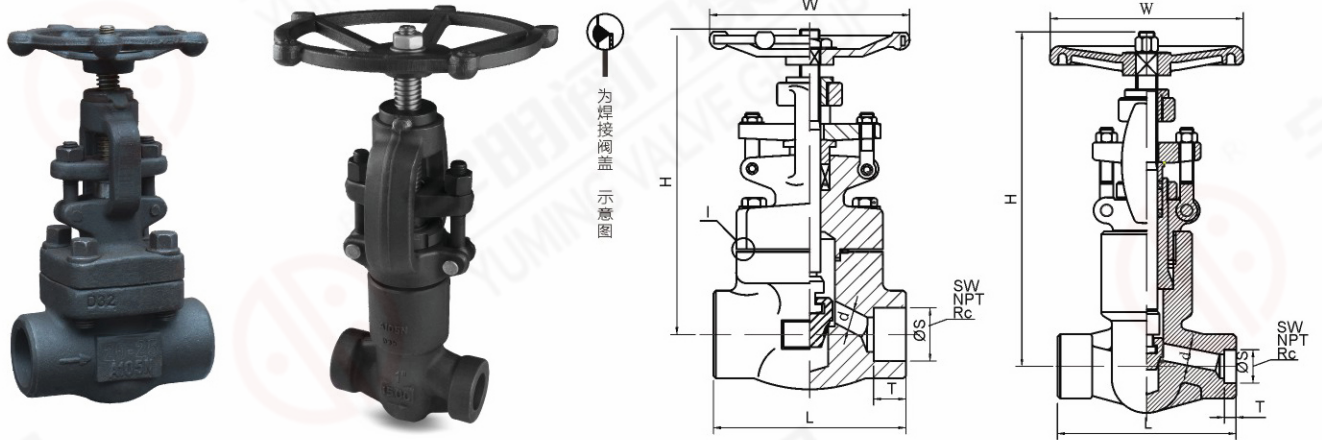

## The main dimensions

unit:mm

NPS	d	L	H	W	ΦS	T
<b>Class:800Lb PN140</b>						
1/2"	10.5	79	158	100	端口尺寸 SW NPT RC	
3/4"	13	92	160	100		
1"	18	111	197	125		
1 1/4"	24	120	228	160		
1 1/2"	29	150	246	160		
2"	36.5	172	290	180		
<b>Class:1500Lb PN250</b>						
1/2"	10.5	111	206	125	端口尺寸 SW NPT RC	
3/4"	13	111	206	125		
1"	18	120	230	160		
1 1/4"	24	152	262	160		
1 1/2"	29	172	296	180		
2"	36.5	200	335	200		
<b>Class:2500Lb</b>						
1/2"	10.5	186	350	250	端口尺寸 SW NPT RC	
3/4"	13.5	186	350	250		
1"	18	186	350	250		
1 1/4"	24	228	480	280		
1 1/2"	29	228	480	280		
2"	36.5	276	520	280		

# Lift check valve

● H41H(Y/W) -16-25C/P/R/I

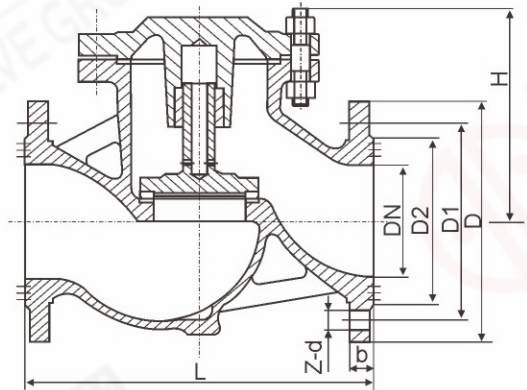

## The main dimensions

unit:mm

DN	L	D	D1	D2	D6	b	Z-Φd	H
		H41H-16C	H41W-16C	H41W-16P	H41W-16R	H41W-16I		
15	130	95	65	45	-	14	4-14	77
20	150	105	75	55	-	14	4-14	77
25	160	115	85	65	-	14	4-14	80
32	180	135	100	78	-	16	4-18	85
40	200	145	110	85	-	16	4-18	95
50	230	160	125	100	-	16	4-18	105
65	290	180	145	120	-	18	4-18	120
80	310	195	160	135	-	20	8-18	130
100	350	215	180	155	-	20	8-18	140
125	400	245	210	185	-	22	8-18	155
150	480	280	240	210	-	24	8-23	180
200	600	335	295	265	-	26	12-23	215
250	730	405	355	320	-	30	12-25	260
300	850	460	410	375	-	34	12-25	315
		H41H-25	H41W-25	H41W-25	H41W-25P	H41W-25R	H41W-25I	
15	130	95	65	45	-	16	4-Φ14	100
20	150	105	75	55	-	16	4-Φ14	105
25	160	115	85	65	-	16	4-Φ14	120
32	180	135	100	78	-	18	4-Φ18	130
40	200	145	110	85	-	18	4-Φ18	135
50	230	160	125	100	-	20	4-Φ18	149
65	290	180	145	120	-	22	8-Φ18	160
80	310	195	160	135	-	22	8-Φ18	169
100	350	230	190	160	-	24	8-Φ23	194
125	400	270	220	180	-	28	8-Φ25	222
150	480	300	250	218	-	30	8-Φ25	255
200	600	360	310	278	-	34	12-Φ25	305
250	730	425	370	332	-	36	12-Φ30	355
300	850	485	430	390	-	40	16-Φ30	410



# Lift check valve

● H41H(Y/W) -40-64C/P/R/I

## The main dimensions

unit:mm

DN	L	D	D1	D2	D6	B	Z-Φd	H
		<b>H41H-40</b>	<b>H41W-40</b>	<b>H41W-40P</b>	<b>H41W-40R</b>	<b>H41W-40I</b>		
15	130	95	65	45	40	16	4-Φ14	100
20	150	105	75	55	51	16	4-Φ14	105
25	160	115	85	65	58	16	4-Φ14	120
32	180	135	100	78	66	18	4-Φ18	130
40	200	145	110	85	76	18	4-Φ18	135
50	230	160	125	100	88	20	4-Φ18	149
65	290	180	145	120	110	22	8-Φ18	160
80	310	195	160	135	121	22	8-Φ18	169
100	350	230	190	160	150	24	8-Φ23	194
125	400	270	220	188	176	28	8-Φ25	225
150	480	300	250	218	204	30	8-Φ25	255
200	600	375	320	282	260	38	12-Φ30	305
250	730	445	385	345	313	42	12-Φ34	360
300	850	510	450	408	364	46	12-Φ34	415

Globe valve series

## The main dimensions

unit:mm

DN	L	D	D1	D2	D6	B	Z-Φd	H
		<b>H41H-64</b>	<b>H41W-64</b>	<b>H41W-64P</b>	<b>H41W-64R</b>	<b>H41W-64I</b>		
15	210	105	75	55	40	18	4-Φ14	100
20	230	125	90	68	51	20	4-Φ18	110
25	230	135	100	78	58	22	4-Φ18	125
32	260	150	110	82	66	24	4-Φ23	140
40	260	165	125	95	76	24	4-Φ23	168
50	300	175	135	105	88	26	4-Φ23	170
65	340	200	160	130	110	28	8-Φ23	188
80	380	210	170	140	121	30	8-Φ23	205
100	430	250	200	168	150	32	8-Φ25	230
125	500	295	240	202	176	36	8-Φ30	230
150	550	340	280	240	204	38	8-Φ34	265
200	650	405	345	300	260	44	12-Φ34	310

# Lift check valve

● H44H(Y/W)型-C/P/R/I

## Structural advantages and features

1. The product is designed and manufactured according to national standard GB/T12236, with reasonable structure, reliable sealing and excellent performance.

2. The sealing surface of valve disc and valve body is made of iron-based alloy or Selite base hard alloy. It is wear-resisting, high-temperature resistant, corrosion-resistant, and has good anti-scuffing performance and long service life.

3. Various piping flange standards and flange sealing surface types can be adopted to meet various engineering needs and user requirements.

4. The valve body material is complete in variety, and the gasket can be reasonably selected according to actual working conditions or user requirements, and can be applied to various pressures, temperatures and medium working conditions.

5. The valve flap rotates around the pin outside the valve seat, reducing the violent impact of closing.

6. The pin-shaft and the valve flap are connected by a built-in structure, there is no external leakage point, and the use is more reliable.

## Standards and specifications

Design and Manufacturing	Structure length	Pressure temperature rating	Flange connection	Test
GB/T12236	GB/T12221	GB/T12224	GB/T9113 HG 20592-20635	JB/T 9092 GB/T26480

## Performance parameters

Name	PN16	PN25	PN40	PN64	PN100	PN160	PN200
Nominal pressure(MPa)	1.6	2.5	4.0	6.4	10	16	20
Shell strength	1.5 time Nominal pressure						
High pressure sealing test(MPa)	1.0 time Nominal pressure						
Normal temperature working pressure	≤1.6	≤2.5	≤4.0	≤6.4	≤10	≤16	≤20

## Main part material

Name	Material			
body	WCB	A351CF8	15CrMo	15Cr1Mo1V
bonnet	WCB	A351CF8	15CrMo	20CrMoV
disc	A105	A351CF8	15CrMo	20CrMoV
seal	13Cr/STL	W/Y/F	STL	STL
pin	20Cr3	06Cr19Ni10	15CrMo	15Cr1Mo1V/F22
gasket	304+flexible graphite	PTFE	304+flexible graphite	304+flexible graphite
bolt	35CrMoA/35#	A193 B8	35CrMoA/A193-B16	35CrMoA/A193-B16
nut	30CrMo/25#	A194 8	30CrMo/A194-4	30CrMo/A194-4
operating temperature	-29~425°C	-196~425°C	-29~550°C	-29~570°C
suitable medium	water/steam/oil/ect	Nitric acid weak corrosive medium	water/steam/oil/ect	water/steam/oil/ect



# Swing check valve

● H44H(Y)-16-25C/P/R/I

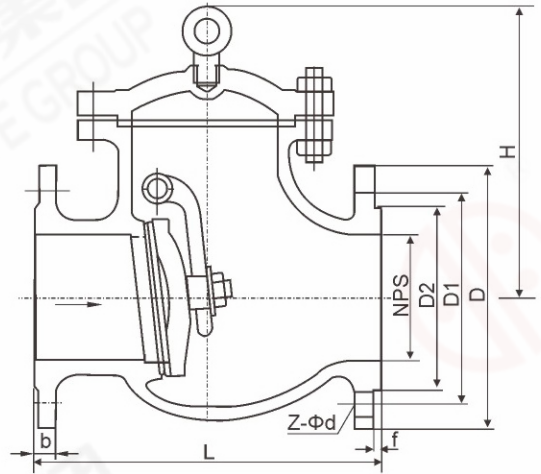
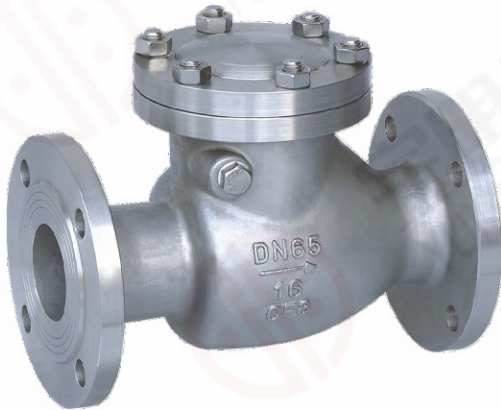

Main connection size

unit:mm

SIZE DN	L	D	D1	D2	b	Z-Φd	H
		<b>H44H-16C</b>	<b>H44W-16C</b>	<b>H44W-16P</b>	<b>H44W-16R</b>	<b>H44W-16I</b>	
50	230	160	125	100	16	4-Φ18	135
65	290	180	145	120	18	4-Φ18	142
80	310	195	160	135	20	8-Φ18	165
100	350	215	180	155	20	8-Φ18	180
125	400	245	210	185	22	8-Φ18	210
150	480	280	240	210	24	8-Φ23	233
200	500	335	295	265	26	12-Φ23	304
250	550	405	355	320	30	12-Φ25	348
300	650	460	410	375	30	12-Φ25	390
350	750	520	470	435	34	16-Φ25	430
400	850	580	525	485	36	16-Φ30	468
450	950	640	585	545	40	20-Φ30	523
500	1025	705	650	608	44	20-Φ34	525
		<b>H44H-25</b>	<b>H44W-25</b>	<b>H44W-25P</b>	<b>H44W-25R</b>	<b>H44W-25I</b>	
50	230	160	125	100	20	4-Φ18	16
65	290	180	145	120	22	8-Φ18	175
80	310	195	160	135	22	8-Φ18	185
100	350	230	190	160	24	8-Φ23	220
125	400	270	220	188	28	8-Φ25	248
150	480	300	250	218	30	8-Φ25	276
200	550	360	310	278	34	12-Φ25	350
250	650	425	370	332	36	12-Φ30	410
300	750	485	430	390	40	16-Φ30	430
350	850	550	490	448	44	16-Φ34	518
400	950	610	550	505	48	16-Φ34	560
450	1025	660	600	555	50	20-Φ34	582
500	1150	730	660	610	52	20-Φ41	618

# Swing check valve

● H44H(Y) -40-64C/P/R/I

Main connection size

unit:mm

SIZE DN	L	D	D1	D2	D6	b	f	f1	Z-Φd	H
		H44H-40	H44Y-40	H44W-40P	H44W-40R	H44W-40I				
50	230	160	125	100	88	20	3	4	4-Φ18	169
65	290	180	145	120	110	22	3	4	8-Φ18	173
80	310	195	160	135	121	22	3	4	8-Φ18	185
100	350	230	190	160	150	24	3	4.5	8-Φ23	220
125	400	270	220	188	176	28	3	4.5	8-Φ25	248
150	480	300	250	218	204	30	3	4.5	8-Φ25	270
200	550	375	320	282	206	38	3	4.5	12-Φ30	342
250	650	445	385	345	313	42	3	4.5	12-Φ34	401
300	750	510	450	408	364	46	4	4.5	16-Φ34	423
350	850	570	510	465	422	52	4	5	16-Φ34	455
400	950	655	585	535	474	58	4	5	16-Φ41	510

Main connection size

unit:mm

SIZE DN	L	D	D1	D2	D6	b	f	f1	Z-Φd	H
		H44H-64	H44Y-64	H44W-64P	H44W-64R	H44W-64I				
50	300	175	135	105	88	26	3	4	4-Φ23	177
65	340	200	160	130	110	28	3	4	8-Φ23	197
80	380	210	170	140	121	30	3	4	8-Φ23	212
100	430	250	200	168	150	32	3	4.5	8-Φ25	248
125	500	295	240	202	176	36	3	4.5	8-Φ30	296
150	550	340	280	240	204	38	3	4.5	8-Φ34	330
200	650	405	345	300	260	44	3	4.5	12-Φ34	385
250	775	470	400	352	313	48	3	4.5	12-Φ41	445
300	900	530	460	412	364	54	4	4.5	16-Φ41	474
350	1025	595	525	475	422	60	4	5	16-Φ41	514
400	1150	670	585	525	474	66	4	5	16-Φ48	616



# American Standard Swing Check Valve

● Class-150Lb~600Lb



## Executive standard

model	Design and manufacture	Structure length	Flange size	Pressure~temp	Test
swing check valve	ANSIB16.34	ANSI B16.10	ANSI B16.5	ANSI B16.34	API598

## Performance specifications

Nominal pressure	Strength test		Water seal test		Air seal test	
	MPa	Lbf/in <sup>2</sup>	MPa	Lbf/in <sup>2</sup>	MPa	Lbf/in <sup>2</sup>
Lb						
150	3.1	450	2.2	315	0.5~0.7	60~100
300	7.8	1125	5.6	815	0.5~0.7	60~100
600	15.3	2225	11.2	1630	0.5~0.7	60~100
900	23.1	3350	16.8	2440	0.5~0.7	60~100

## Main part material

body/bonnet/disc	pin	gasket	seal	operating temperature	suitable medium
WCB	2Cr13	Flexible graphite 1Cr13 Stainless steel acid-resistant asbestos	13Cr STL body material	≤425	water steam oil
WC1	2Cr13			≤450	
WC6	2Cr13			≤540	
WC9	2Cr13			≤570	
C5 C12	2Cr13	PTFE Tooth washer	PTFE nylon	≤550	Nitric acid/acetic acid strong oxidizing medium urea
CF8	304			≤200 expensive media	
CF3	316				
CF8M	304L				
CF3M	316L				

# American Standard Swing Check Valve

● Class-150Lb~600Lb

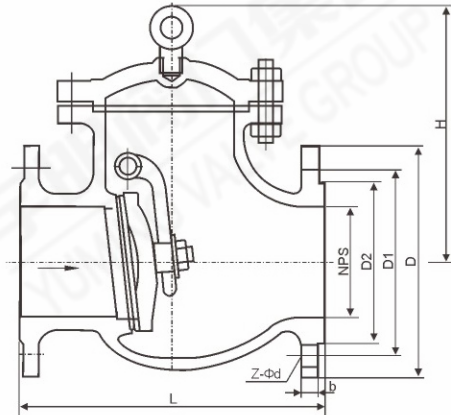

The main connection size

unit:mm

NPS in	DN mm	L	D	D1	D2	b	Z-φd	H
<b>Class150</b>								
2"	50	203	157	120.7	92	19.50	4-φ19	161
2 1/2"	65	216	178	139.7	105	22.5	4-φ19	180
3"	80	241	190.5	152.4	127	24	4-φ19	190
4"	100	292	229	190.50	157.2	24	8-φ19	220
6"	150	356	279	241.5	216	25.5	8-φ22.5	257
8"	200	495	343	298.5	270	29	8-φ22.5	292
10"	250	622	406	362	324	30.5	12-φ25	350
12"	300	698	483	432	381	32	12-φ25	398
14"	350	787	533	476.8	413	35	12-φ29	445
16"	400	864	597	539.8	470	37	16-φ29	490
18"	450	978	635	577.8	533	40	16-φ32	520
20"	500	978	698	635	584	43	20-φ32	546
24"	600	1295	813	749.3	692	48	20-φ35	880
<b>Class300</b>								
2"	50	267	165	127	92	22.5	8-φ19	179.5
2 1/2"	65	292	190	150	105	25	8-φ22	190
3"	80	318	210	168	127	29.0	8-φ22.5	212.4
4"	100	356	254	200	157	32.0	8-φ22.5	246
6"	150	445	317.5	269.7	216	37.0	12-φ22.5	292
8"	200	533	381	330	270	41.5	12-φ25.5	328
10"	250	622	444.5	387	324	48.0	16-φ28.5	378.6
12"	300	711	521	451	381	51.0	16-φ32	420
14"	350	838	584	514	54	54	20-φ32	470
16"	400	864	648	572	57	57	20-φ35	530
18"	450	978	711	629	60	60	24-φ35	584
20"	500	1016	775	686	64	64	24-φ35	610
24"	600	1346	914	813	70	70	24-φ41	860
<b>Class600</b>								
2"	50	292	165	127	92	25	8-φ19	203
2 1/2"	65	330	190	150	105	29	8-φ22	229
3"	80	356	210	168	127	32	8-φ22	235
4"	100	432	273	216	157	38	8-φ25	286
6"	150	559	356	292	216	48	8-φ29	330
8"	200	660	419	349	270	56	12-φ29	381
10"	250	787	508	432	324	64	12-φ32	457
12"	300	838	559	489	381	67	16-φ35	584
14"	350	889	603	527	413	70	20-φ38	635
16"	400	991	686	603	470	76	20-φ41	684

Check valve series



# Soft seal Wafer Butterfly Valve

- D71X/F/F46
- D371X/F/F46
- D671X/F/F46
- D971X/F/F46

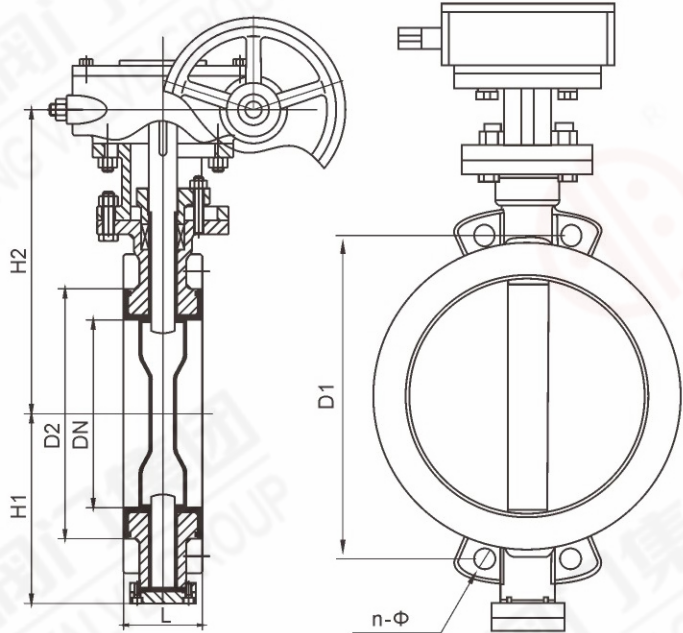

### Application

It is mainly used in corrosive mediums such as petroleum, printing and dyeing, chemical industry, etc., as cutting and flow regulation.

### Features

The structure is simple, compact, and the operating torque is small. The 90° rotation is quick to open and the installation and maintenance are convenient. The sealing material is resistant to corrosion, aging, and long service life.

### Standard specification

design standards	GB/T12238
structure length	GB/T12221
flange connection size	GB/T9113 HG/T20592
test	GB/T13927

### Main part material

body	Q235A, WCB, CF8, CF8M
disc	Q235A, WCB, CF8, CF8M
lining	EPDM/F46
stem	20Cr13, 304, 316
packing	PTFE

# Soft seal Wafer Butterfly Valve

- D71X/F/F46
- D371X/F/F46
- D671X/F/F46
- D971X/F/F46

## The main connection size

DN	L	H1	H2	D1	D2	N-Φ
<b>PN10</b>						
50	43	85	196	125	100	4-18
65	46	90	211	145	120	4-18
80	46	100	230	160	135	4-18
100	52	107	256	180	155	4-18
125	56	123	288	210	185	4-18
150	56	140	315	240	210	4-22
200	60	180	350	295	265	4-22
250	68	200	398	350	320	4-22
300	78	250	431	400	370	4-22
350	78	270	478	460	430	4-M20
400	102	350	513	515	480	4-M24
450	114	365	550	565	530	4-M24
500	127	410	615	620	585	4-M24
600	154	470	670	725	685	4-M27
700	165	495	750	840	795	4-M27
800	190	575	820	950	900	4-M30
900	203	620	895	1050	1000	4-M30
1000	216	680	990	1160	1115	4-M33

## The main connection size

DN	L	H1	H2	D1	D2	N-Φ
<b>PN16</b>						
50	43	85	196	125	100	4-18
65	46	90	211	145	120	4-18
80	46	100	230	160	135	4-18
100	52	107	256	180	155	4-18
125	56	123	288	210	185	4-18
150	56	140	315	240	210	4-23
200	60	180	350	295	265	4-23
250	68	200	398	355	320	4-25
300	78	250	431	410	375	4-25
350	78	270	478	470	435	4-M22
400	102	350	513	525	485	4-M27
450	114	365	550	585	545	4-M27
500	127	410	615	650	610	4-M30
600	154	470	670	770	725	4-M33
700	165	495	750	840	795	4-M33
800	190	575	820	950	900	4-M36
900	203	620	895	1050	1000	4-M36
1000	216	680	990	1170	1115	4-M39



# Soft seal Flange Butterfly Valve

- D41X/F/F46
- D341X/F/F46
- D641X/F/F46
- D941X/F/F46

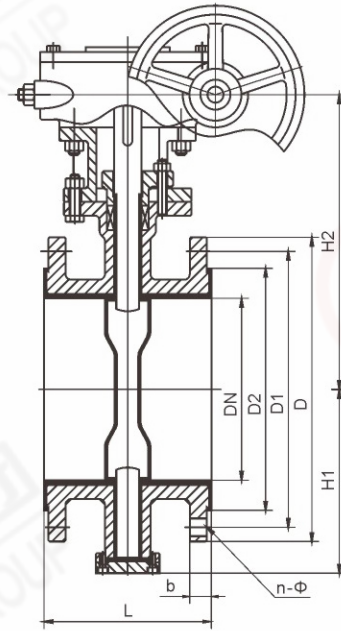

**Applicable**  
 Applicable to oil, chemical, food, medicine, paper, water and electricity pipelines, especially suitable for double-sealed box body easy erosion occasions, as a regulating and cutting equipment.

**Features**  
 The structure is simple, compact, and the operating torque is small. The 90° rotation is quick to open and the installation and maintenance are convenient. The sealing material is resistant to corrosion, aging, and long service life.

## Standard specification

design standards	GB/T12238
structure length	GB/T12221
flange connection size	GB/T9113 HG/T20592
test	GB/T13927

## Main part material

body	WCB, QT-450
disc	WCB, QT-450
stem	20Cr13
packing	PTFE/flexible graphite
lining	EPDM/F46

# Soft seal Flange Butterfly Valve

- D41X/F/F46
- D341X/F/F46
- D641X/F/F46
- D941X/F/F46

## The main connection size

DN	L	H1	H2	D	D1	D2	b	N-Φ
PN10								
50	108	85	196	160	125	100	18	4-18
65	112	90	211	180	145	120	18	4-18
80	114	100	230	195	160	135	20	8-18
100	127	107	256	215	180	155	20	8-18
125	140	123	288	245	210	185	22	8-18
150	140	140	315	280	240	210	22	8-22
200	152	180	350	335	295	265	24	8-22
250	165	200	398	395	350	320	24	12-22
300	178	250	431	445	400	370	26	12-22
350	190	270	478	505	460	430	26	16-22
400	216	350	513	565	515	480	28	16-26
450	222	365	550	615	565	530	28	20-26
500	229	410	615	670	620	585	30	20-26
600	267	470	670	780	725	685	30	20-30
700	292	495	750	895	840	795	32	24-30
800	318	575	820	1015	950	900	34	24-33
900	330	620	895	1115	1050	1000	36	28-33
1000	410	680	990	1230	1160	1115	38	28-36
1200	470	790	1150	1455	1380	1330	42	32-39
1400	530	870	1260	1675	1590	1530	48	36-42
1600	600	1010	1380	1915	1820	1750	52	40-48
1800	670	1100	1500	2115	2020	1950	56	44-48
2000	760	1200	1600	2325	2230	2150	60	48-48

## The main connection size

DN	L	H1	H2	D	D1	D2	b	N-Φ
PN16								
50	108	85	196	160	125	100	20	4-18
65	112	90	211	180	145	120	20	4-18
80	114	100	230	195	160	135	20	8-18
100	127	107	256	215	180	155	22	8-18
125	140	123	288	245	210	185	22	8-18
150	140	140	315	280	240	210	24	8-23
200	152	180	350	335	295	265	24	12-23
250	165	200	398	405	355	320	26	12-25
300	178	250	431	460	410	375	28	12-25
350	190	270	478	520	470	435	30	16-25
400	216	350	513	580	525	485	32	16-30
450	222	365	550	640	585	545	34	20-30
500	229	410	615	715	650	610	36	20-33
600	267	470	670	840	770	725	38	20-36
700	292	495	750	910	840	795	40	24-36
800	318	575	820	1025	950	900	42	24-39
900	330	620	895	1125	1050	1000	46	28-39
1000	410	680	990	1255	1170	1115	50	28-42
1200	470	790	1150	1485	1390	1330	54	32-48
1400	530	870	1260	1685	1590	1530	58	36-48
1600	600	1010	1380	1930	1820	1750	62	40-55
1800	670	1100	1500	2130	2020	1950	66	44-55
2000	760	1200	1600	2345	2230	2150	70	48-60



# Cast steel Metal seal Wafer Butterfly Valve

- D73H
- D373H
- D673H
- D973H

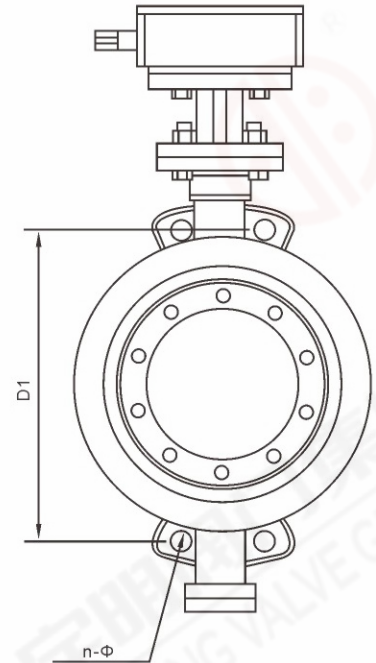
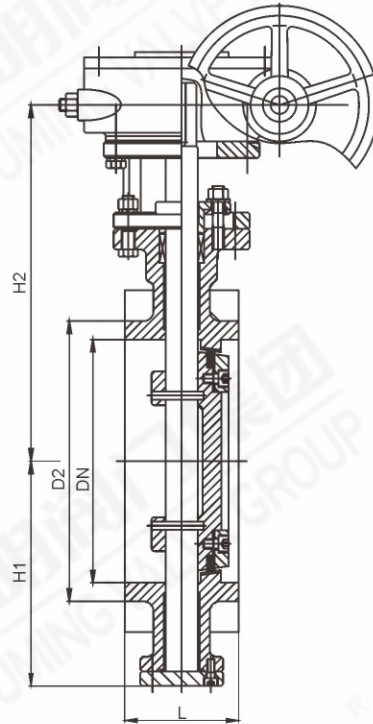

Butterfly valve series

### Applicable

The three-clamp triple eccentric hard-seal butterfly valve is mainly used as regulating and shut-off devices on pipelines with high temperature, high pressure and erosion, such as petroleum, chemical industry, metallurgy, plumbing, and water and electricity.

### Features

The unique design with three eccentricities uses almost no wear on the valve seat and the butterfly plate. The tighter sealing function enables zero leakage and extends the service life of the valve. And using the clip structure using its compact, small size, light weight and other features to facilitate the installation and maintenance.

### Standard specification

design standards	GB/T12238 JB/T8527
structure length	GB/T12221
flange connection size	GB/T9113 HG/T20592
test	GB/T13927

### Main part material

body	Q235A, WCB, CF8, CF8M
disc	Q235A, WCB, CF8, CF8M
seal	304/316 201+Wear-resistant cardboard
stem	20Cr13, 304, 316
packing	flexible graphite

# Cast steel Metal seal Wafer Butterfly Valve

- D73H
- D373H
- D673H
- D973H

## The main connection size

DN	L	H1	H2	D1	D2	N-Φ
PN10						
50	43	85	196	125	100	4-18
65	46	90	211	145	120	4-18
80	49	100	230	160	135	4-18
100	56	107	256	180	155	4-18
125	64	123	288	210	185	4-18
150	70	140	315	240	210	4-22
200	71	180	350	295	265	4-22
250	76	200	398	350	320	4-22
300	83	250	431	400	370	4-22
350	92	270	478	460	430	4-M20
400	102	350	513	515	480	4-M24
450	114	365	550	565	530	4-M24
500	127	410	615	620	585	4-M24
600	154	470	670	725	685	4-M27
700	165	495	750	840	795	4-M27
800	190	575	820	950	900	4-M30
900	203	620	895	1050	1000	4-M30
1000	216	680	990	1160	1115	4-M33

## The main connection size

DN	L	H1	H2	D1	D2	N-Φ
PN16						
50	43	85	196	125	100	4-18
65	46	90	211	145	120	4-18
80	49	100	230	160	135	4-18
100	56	107	256	180	155	4-18
125	64	123	288	210	185	4-18
150	70	140	315	240	210	4-23
200	71	180	350	295	265	4-23
250	76	200	398	355	320	4-25
300	83	250	431	410	375	4-25
350	92	270	478	470	435	4-M22
400	102	350	513	525	485	4-M27
450	114	365	550	585	545	4-M27
500	127	410	615	650	610	4-M30
600	154	470	670	770	725	4-M33
700	165	495	750	840	795	4-M33
800	190	575	820	950	900	4-M36
900	203	620	895	1050	1000	4-M36
1000	216	680	990	1170	1115	4-M39



# Cast steel Metal seal Flange Butterfly Valve

- D43H
- D343H
- D643H
- D943H

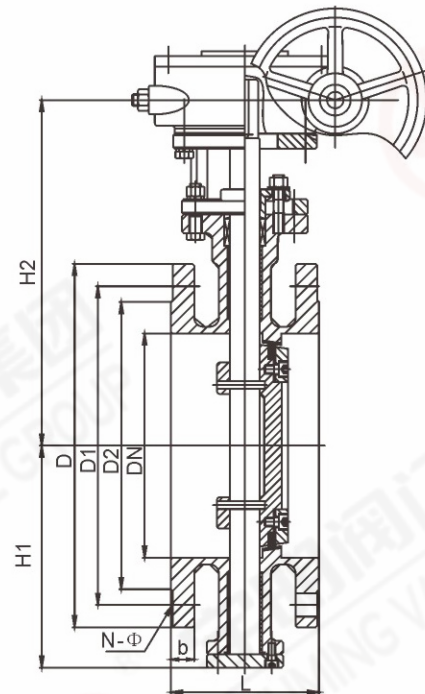

Three-eccentric hard-seal butterfly valve is a new type of butterfly valve designed by our company with advanced three-eccentric structure and designed for high temperature, high pressure, and obvious erosion.

### Applicable

The three-clamp triple eccentric hard-seal butterfly valve is mainly used as regulating and shut-off devices on pipelines with high temperature, high pressure and erosion, such as petroleum, chemical industry, metallurgy, plumbing, and water and electricity.

### Features

Three-eccentric hard-seal butterfly valve body and valve seat body structure, the center of the stem and the sealing surface center, the valve body center has a certain eccentric distance, the sealing surface and the valve body centerline has an offset angle, so that the valve When the door is opened and closed, there is no friction between the butterfly plate and the valve body, thereby prolonging the service life of the valve.

### Standard specification

design standards	GB/T12238 JB/T8527
structure length	GB/T12221
flange connection size	GB/T9113 HG/T20592
test	GB/T26480

### Main part material

body	Q235A, WCB, CF8, CF8M
disc	Q235A, WCB, CF8, CF8M
seal	304/316 201+Wear-resistant cardboard
stem	20Cr13, 304, 316
packing	flexible graphite

# Cast steel Metal seal Flange Butterfly Valve

● D43H ● D343H ● D643H ● D943H

## The main connection size

DN	L	H1	H2	D	D1	D2	b	N-Φ
PN10								
50	108	85	196	160	125	100	18	4-18
65	112	90	211	180	145	120	18	4-18
80	114	100	230	195	160	135	20	8-18
100	127	107	256	215	180	155	20	8-18
125	140	123	288	245	210	185	22	8-18
150	140	140	315	280	240	210	22	8-22
200	152	180	350	335	295	265	24	8-22
250	165	200	398	395	350	320	24	12-22
300	178	250	431	445	400	370	26	12-22
350	190	270	478	505	460	430	26	16-22
400	216	350	513	565	515	480	28	16-26
450	222	365	550	615	565	530	28	20-26
500	229	410	615	670	620	585	30	20-26
600	267	470	670	780	725	685	30	20-30
700	292	495	750	895	840	795	32	24-30
800	318	575	820	1015	950	900	34	24-33
900	330	620	895	1115	1050	1000	36	28-33
1000	410	680	990	1230	1160	1115	38	28-36
1200	470	790	1150	1455	1380	1330	42	32-39
1400	530	870	1260	1675	1590	1530	48	36-42
1600	600	1010	1380	1915	1820	1750	52	40-48
1800	670	1100	1500	2115	2020	1950	56	44-48
2000	760	1200	1600	2325	2230	2150	60	48-48
2200	800	1310	1710	2550	2440	2370	64	52-56
2400	850	1410	1825	2760	2650	2570	70	56-56
2600	900	1535	1940	2960	2850	2780	78	60-56
2800	950	1640	2060	3180	3070	3000	86	64-56
3000	1000	1745	2180	3405	3290	3210	92	68-62



# Cast steel Metal seal Flange Butterfly Valve

● D43H ● D343H ● D643H ● D943H

## The main connection size

DN	L	H1	H2	D	D1	D2	b	N-Φ
PN16								
50	108	85	196	160	125	100	20	4-18
65	112	90	211	180	145	120	20	4-18
80	114	100	230	195	160	135	20	8-18
100	127	107	256	215	180	155	22	8-18
125	140	123	288	245	210	185	22	8-18
150	140	140	315	280	240	210	24	8-23
200	152	180	350	335	295	265	24	12-23
250	165	200	398	405	355	320	26	12-25
300	178	250	431	460	410	375	28	12-25
350	190	270	478	520	470	435	30	16-25
400	216	350	513	580	525	485	32	16-30
450	222	365	550	640	585	545	34	20-30
500	229	410	615	715	650	610	36	20-33
600	267	470	670	840	770	725	38	20-36
700	292	495	750	910	840	795	40	24-36
800	318	575	820	1025	950	900	42	24-39
900	330	620	895	1125	1050	1000	46	28-39
1000	410	680	990	1255	1170	1115	50	28-42
1200	470	790	1150	1485	1390	1330	54	32-48
1400	530	870	1260	1685	1590	1530	58	36-48
1600	600	1010	1380	1930	1820	1750	62	40-55
1800	670	1100	1500	2130	2020	1950	66	44-55
2000	760	1200	1600	2345	2230	2150	70	48-60
PN25								
50	108	85	196	160	125	100	20	4-18
65	112	90	211	180	145	120	22	8-18
80	114	100	230	195	160	135	22	8-18
100	127	107	256	230	190	160	24	8-23
125	140	123	288	270	220	185	26	8-25
150	140	140	315	300	250	215	28	8-25
200	152	180	350	360	310	275	30	12-25
250	165	200	398	425	370	330	32	12-30
300	178	250	431	485	430	390	34	16-30
350	190	270	478	555	490	448	38	16-33
400	216	350	513	620	550	505	40	16-36
450	222	365	550	670	600	550	42	20-36
500	229	410	615	730	660	610	44	20-36
600	267	470	670	845	770	720	46	20-39
700	292	495	750	960	875	820	50	24-42
800	318	575	820	1085	990	930	54	24-48
900	330	620	895	1185	1090	1025	58	28-48
1000	410	680	990	1320	1210	1140	62	28-56
1200	470	790	1150	1530	1420	1350	70	32-56
1400	530	870	1260	1755	1640	1560	78	36-60
1600	600	1010	1380	1975	1860	1780	86	40-60
1800	670	1100	1500	2195	2070	1985	94	44-68
2000	760	1200	1600	2425	2300	2210	102	48-68

Butterfly valve series

# Flange Y-Strainer

- GL41-16
- GL41-16Q
- GL41-25Q

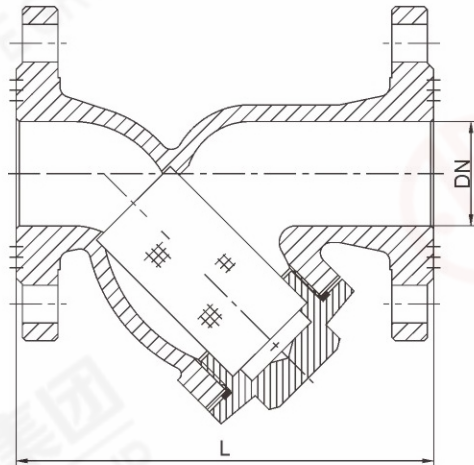

Strainer series

The filter is an indispensable device for conveying the medium piping system and is usually installed at the inlet end of a pressure reducing valve, a pressure relief valve, a leveling valve or other equipment. Used to remove impurities in the medium to protect the normal use of valves and equipment.

## Performance specifications

Nominal pressure PN(MPa)	shell test pressure(MPa)	proper temperature °C		suitable medium
		grey cast iron	ductile iron	
1.6	2.4	0~200	-10~350	water/steam/oil

## Main part material

body/bonnet	HT200, QT400-15
filter	1Cr18Ni9Ti(汽:40~90目、水:18~30目、油:40~60目)

## GL41-16 Dimensions

DN(mm)	20	25	32	40	50	65	80	100	125	150	200
L	140	160	190	220	240	280	290	310	440	480	600



# Cast steel/stainless steel Y-Strainer

- GL41W/H-16C/P/R
- GL41W/H-25C/P/R

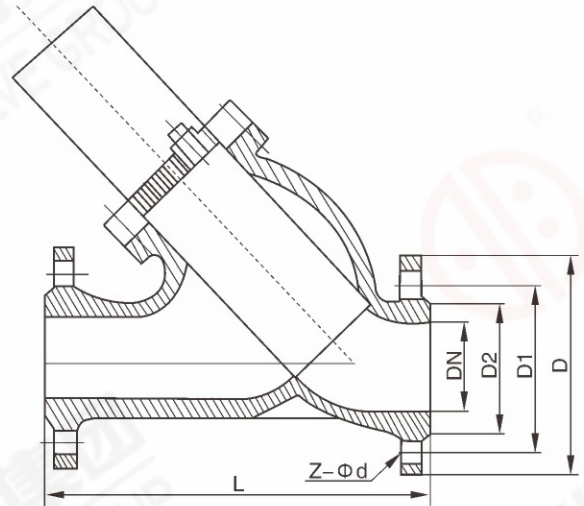

## Technical Parameters

model	connection size	nominal pressure	shell test pressure	working pressure	shell material	filter	mesh area
GL41W/H-16	flange	1.6	2.4	1.6	Carbon steel	stainless steel	3-4DN
GL41W/H-25	flange	2.5	3.8	2.5	Carbon steel	stainless steel	

## The main dimensions

unit:mm

DN(mm)	L	PN16				PN25			
		D	D1	D2	Z-Φd	D	D1	D2	Z-Φd
PN16C/P/R    PN25C/P/R									
15	130	95	65	45	4-14	95	65	45	4-14
20	145	105	75	55	4-14	105	75	55	4-14
25	150	115	85	65	4-18	115	85	65	4-18
32	185	135	100	78	4-18	135	100	78	4-18
40	190	145	110	85	4-18	145	110	85	4-18
50	210	160	125	100	4-18	160	125	100	4-18
65	250	180	145	120	4-18	180	145	120	8-18
80	280	195	160	135	8-18	195	160	135	8-18
100	310	215	180	155	8-18	230	190	160	8-23
125	345	245	210	185	8-18	270	220	188	8-25
150	385	280	240	210	8-23	300	250	218	8-25
200	485	335	295	265	12-23	360	310	278	12-25

# American standard Strainer

● GL41W-150LB~600LB

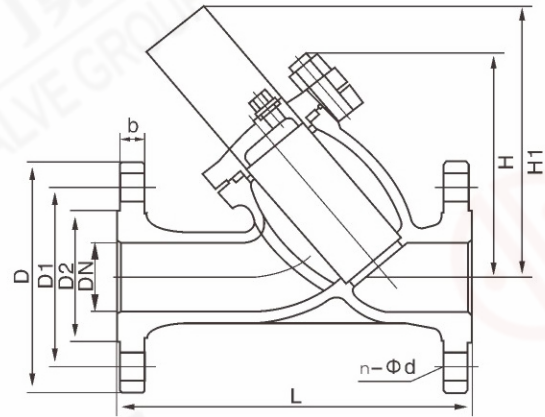

NPS≥11/2in

## Executive standard

Design and manufacture	Structure length	Flange size	Pressure ~ Temp	Test
JIS B2071 B2081	JIS B2002	JIS B2212 B2214	JIS B2017 B2081	JIS B2003
ANSI B16.34	ANSI B16.34	ANSI 16.5	ANSI B16.34	API 598

## Pressure test

Nominal pressure	Strength test		Sealed test tube(liquid)		Sealed test tube(air)	
	MPa	Lbf/in <sup>2</sup>	MPa	Lbf/in <sup>2</sup>	MPa	Lbf/in <sup>2</sup>
150	3.0	430	2.2	315	0.4-0.7	60-100
300	7.7	1110	5.7	815		

## Main part material

body/bonnet/disc	filter	gasket	Operating temperature	Suitable medium
WCB	SS316	Reinforced graphite 1Cr13 Flexible graphite stainless steel Acid-resistant asbestos PTFE Tooth washer	≤425°C	water/steam/oil
WC1			≤450°C	
WC6			≤540°C	
WC9			≤570°C	
C5 C12			≤540°C	
CF8			SS316L	
CF8M	acetic acid			
CF3				
CF3M				



# American standard Strainer

● GL41W-150LB~600LB

## The main connection size

unit:mm

NPS	DN	L	D	D1	n-Φd	D2	b	f
<b>150Lb</b>								
1/2"	15	130	90	60.3	4-16	35	11.6	2
3/4"	20	145	100	64.9	4-16	43	13.2	2
1"	25	150	110	79.4	4-16	51	14.7	2
1 1/4"	32	185	115	88.9	4-16	64	16.3	2
1 1/2"	40	190	125	98.4	4-16	73	17.9	2
2"	50	210	150	120.7	4-19	92	14.5	2
2 1/2"	65	250	180	139.7	4-19	105	22.7	2
3"	80	280	190	152.4	4-19	127	24.3	2
4"	100	310	230	190.5	8-19	157	24.3	2
<b>300Lb</b>								
1/2"	15	130	95	66.7	4-16	35	14.7	2
3/4"	20	145	115	82.6	4-19	43	16.3	2
1"	25	150	125	88.9	4-19	51	17.9	2
1 1/4"	32	185	135	98.4	4-19	64	19.5	2
1 1/2"	40	190	155	114.3	4-22	73	21.1	2
2"	50	210	165	127	8-19	92	22.7	2
2 1/2"	65	250	190	144.2	8-22	105	25.9	2
3"	80	280	210	168.3	8-22	127	29	2
4"	100	310	255	200	8-22	157	32.2	2
<b>600Lb</b>								
1/2"	15	130	95	66.7	4-15.9	34.9	21.3	7
3/4"	20	145	115	82.6	4-19	42.9	22.9	7
1"	25	150	125	88.9	4-19	50.8	24.5	7
1 1/4"	32	185	135	98.4	4-19	63.5	27.7	7
1 1/2"	40	190	15	114.3	4-22.2	73	29.3	7
2"	50	210	165	127	8-19	92.1	32.4	7
2 1/2"	65	250	190	149.2	8-22.2	104.8	35.6	7
3"	80	280	210	168.3	8-22.2	127	38.8	7
4"	100	310	275	215.9	8-25.4	157.2	45.1	7

注：1. 设计与制造符合MFG标准。2. 试验与检验符合API598 3. 结构长度符合MFG标准。4. 法兰尺寸符合ANSI B16.5技术要求。

# Brass Valve Series

## Brass Ball Valve

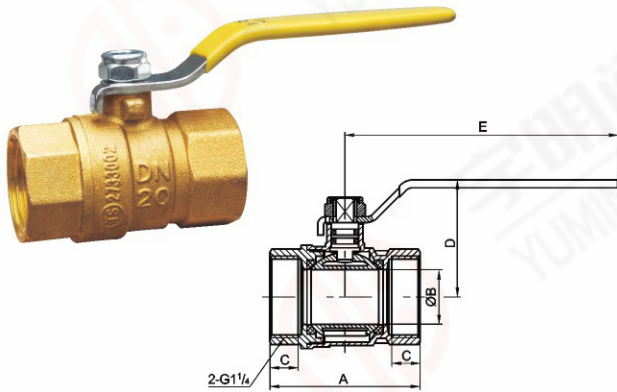

### Model:Q11F-16T

DN	A	B	C	D	E	G
15	51	13	12	39	90	1/2
20	56	18	12	42.3	90	3/4
25	66	22.5	13	53	110	1
32	77	28	14.5	60	140	1 1/4
40	87.4	35	15.5	65.1	140	1 1/2
50	102.2	44	17.5	74	155	2

### Specifications

Nominal pressure:1.6MPa

Working TEMP:-10℃≤T≤100℃

Working medium:Water, non-corrosive liquid

Cylindrical thread meets ISO 228 standard

## Brass Strainer Ball Valve

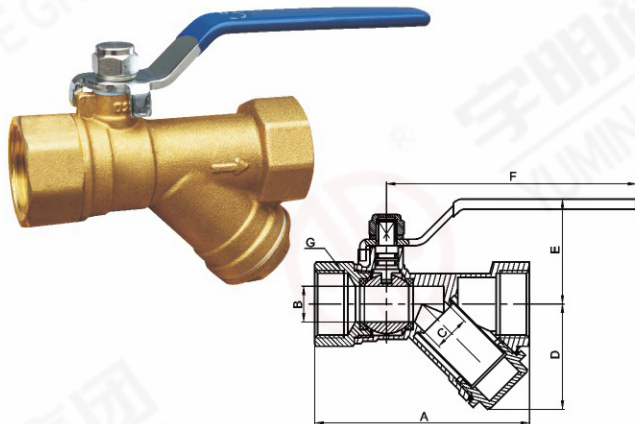

### Model:Q11F-16T

DN	A	B	C	D	E	F	G
15	78.7	12.5	12	37.6	40.2	98	1/2
20	84	14	14	41	41	98	3/4
25	107	19	19	53.1	44.3	98	1

### Specifications

Nominal pressure:1.6MPa

Working TEMP:-10℃≤T≤100℃

Working medium:Water, non-corrosive liquid

## Brass Flange Ball Valve

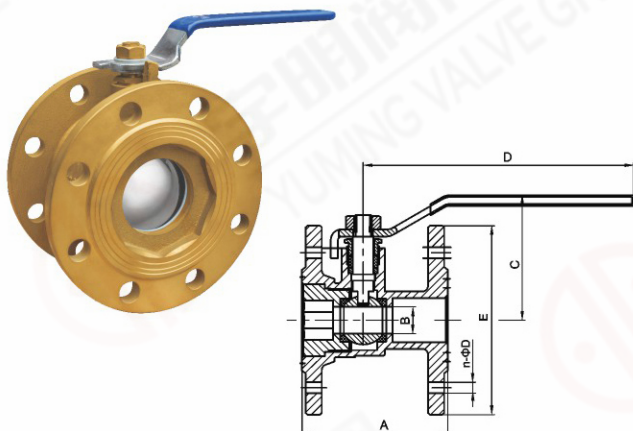

### Model:Q41-16T

DN	A	B	C	D	E	ΦD	n
15	78	12	74	157.5	90	14	4
20	78	15	69	157.5	100	14	4
25	81	20	74	157.5	110	14	4
32	87	25	85.5	167.5	132	18	4
40	102	32	93.7	185.9	143	18	4
50	101	40	105.3	185.9	158	18	4
65	104	50	125.5	215	178	18	8
80	124	65	134.8	218.9	193	18	8
100	136	80	151.8	219	213	18	8

### Specifications

Nominal pressure:1.6MPa

Working TEMP:-20℃≤T≤120℃

Working medium:Water, non-corrosive liquid, saturated steam(≤0.6MPa)

Cylindrical thread meets ISO 228 standard



# Brass Valve Series

Brass Lock Ball Valve

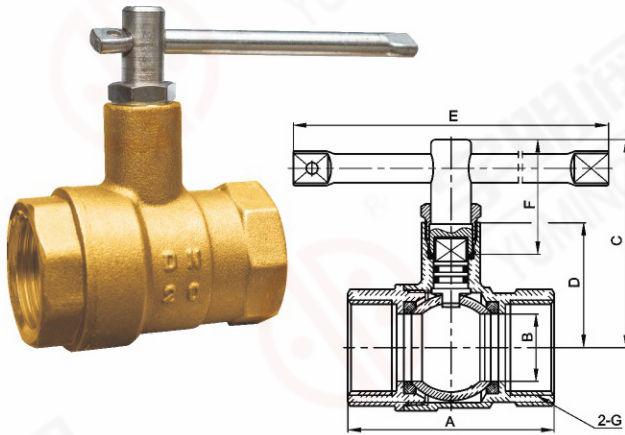

Model:Q11F-16T

DN	A	B	C	D	E	F	G
15	53	12.5	55.5	34.3	84	32	1/2
20	57.5	15	57.5	36.3	84	32	3/4
25	72	23.5	72.6	43.6	160	40	1
32	80	30	77.8	48.8	160	40	1 1/4
40	90.6	37	89.3	56	160	45	1 1/2
50	106	46.5	96.5	63.3	160	45	2

## Specifications

Nominal pressure:1.6MPa

Working TEMP:-10°C≤T≤100°C

Working medium:Water, non-corrosive liquid

Cylindrical thread meets ISO 228 standard

Brass Magnetic Ball Valve

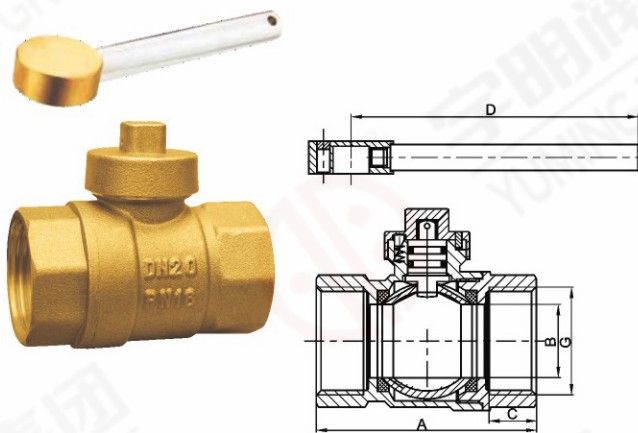

Model:Q11F-16T

DN	A	B	C	D	G
15	52.5	14	12	88	1/2
20	56.5	18	12	88	3/4
25	67.5	22.5	14.5	88	1
32	79	28	15.5	90.5	1 1/4

## Specifications

Nominal pressure:1.6MPa

Working TEMP:-10°C≤T≤100°C

Working medium:Water

Cylindrical thread meets ISO 228-1;2000 standard

Brass Thermometer Ball Valve

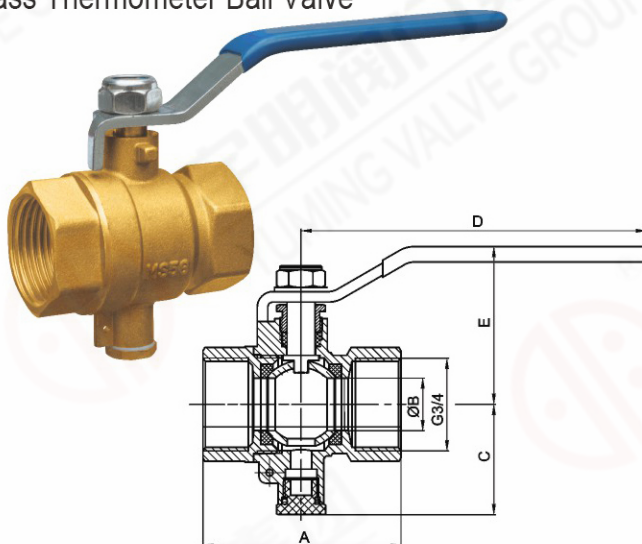

Model:Q11F-16T

DN	A	B	C	D	E	G
15	56.5	15	31.5	98.5	45	3/4
20	67	20	35	110.8	53	1

## Specifications

Nominal pressure:1.6MPa

Working TEMP:-10°C≤T≤100°C

Working medium:Water, non-corrosive liquid, saturated steam(≤0.6MPa)

Cylindrical thread meets ISO 228-1;2000 standard

# Brass Valve Series

## Brass Globe Valve

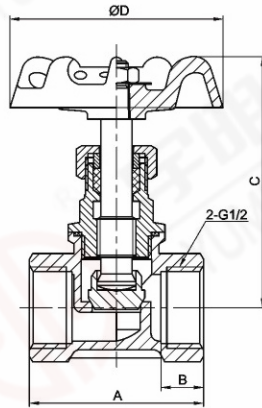
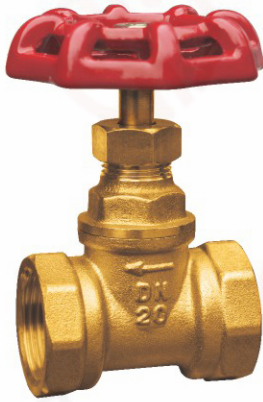

### Model: J11W-16T

DN	Size	A	B	C	D	G
15	1/2	45	11	65~68.5	54	1/2
20	3/4	51	11	71~76	60	3/4
25	1	64.5	15	82~90	72	1
32	1 1/4	75	16	95.4~106.5	80	1 1/4
40	1 1/2	82	17	109~121	100	1 1/2
50	2	100	19	122.5~136	110	2

### Specifications

Nominal pressure: 1.6MPa

Working TEMP: -20°C ≤ T ≤ 150°C

Working medium: Water, non-corrosive liquid, saturated steam (≤ 0.6MPa)

Cylindrical thread meets ISO 228 standard

## Brass Flange Globe Valve

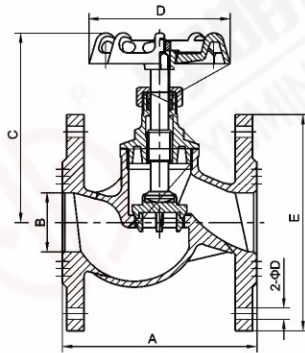
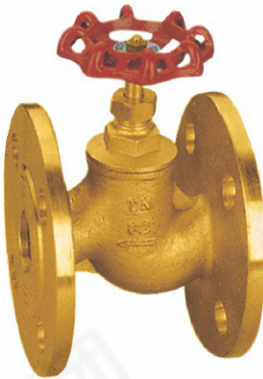

### Model: J41W-16T

DN	A	B	C	D	E	n	ΦD
15	80	15	79-84	54	90	4	14
20	87	20	87-94	60	100	4	14
25	98	25	94-101	72	110	4	14
32	108	32	114-125.5	80	132	4	18
40	133	41	132-142	100	143	4	18
50	211	50	182	125	158	4	18
65	233	63	194-220	179	177	4	18
80	301	79	290-319	200	193	8	18
100	320	102	338-403	236	213	8	18

### Specifications

Nominal pressure: 1.6MPa

Working TEMP: -20°C ≤ T ≤ 150°C

Working medium: Water, non-corrosive liquid, saturated steam (≤ 0.6MPa)

## Brass Balance Valve

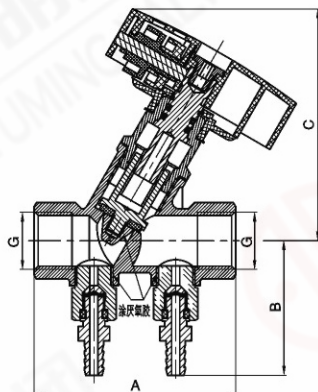

### Model: J15W-16T

DN	Size	A	B	C	G
20	3/4	85	52	85	3/4
25	1	107	56	89.5	1
32	1 1/4	110	60	106.5	1 1/4
40	1 1/2	120	64	117.5	1 1/2
50	2	128	70	127	2

### Specifications

Nominal pressure: 1.6MPa

Working TEMP: 0°C ≤ T ≤ 100°C

Working medium: Water, non-corrosive liquid

补偿接头



# Brass Valve Series

### Brass Strainer

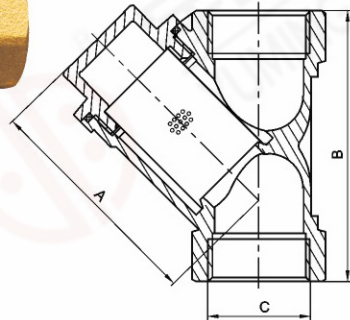
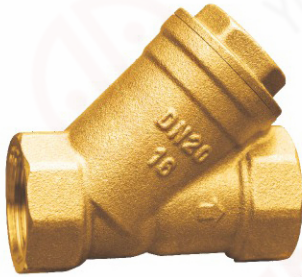

Model:SY11-16T

DN	Size	A	B	C	过滤网目数
15	1/2	48	55.5	1/2	24X24
20	3/4	59	70	3/4	24X24
25	1	69	82	1	24X24
32	1 1/4	81	90	1 1/4	12X9
40	1 1/2	88	101	1 1/2	12X9
50	2	107	123.5	2	12X9
65	2 1/2	149.4	172	2 1/2	12X9

### Specifications

Nominal pressure:1.6MPa

Working TEMP:-0°C≤T≤150°C

Working medium:Water

Cylindrical thread meets ISO 228 standard

### Brass Electric Valve

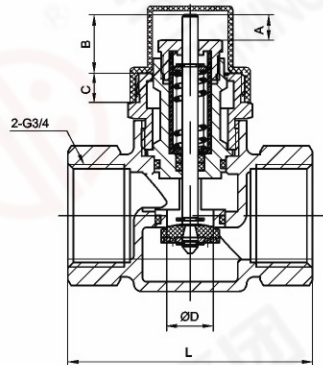
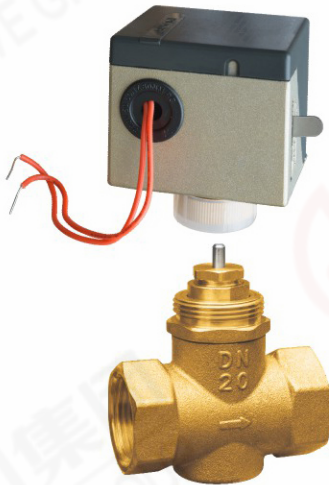

Model:J911X-16T

DN	Size	A	B	C	D	I	G
20	3/4	7	15	7.5	12	63	3/4
25	1	7	15	7.5	16.5	73	1

### Specifications

Nominal pressure:1.6MPa

Working TEMP:1°C≤T≤95°C

Working medium:Water

Cylindrical thread meets ISO 228 standard

Sealing pressure difference:DN20:0.3MPa / DN25:0.1MPa

### Stainless steel full wave bellows

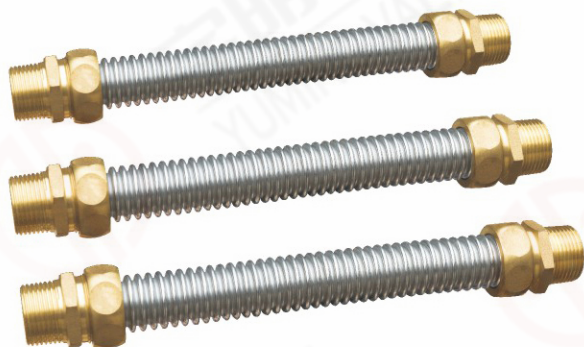

### Stainless steel half-wave bellows

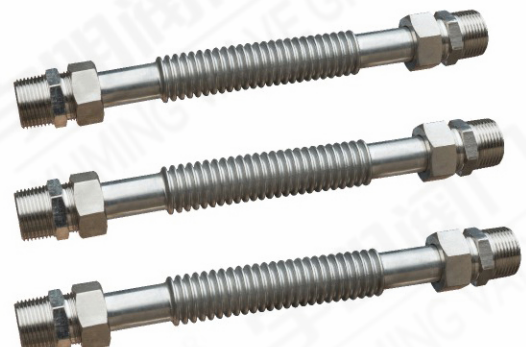

# Brass Valve Series

## Brass Gate Valve

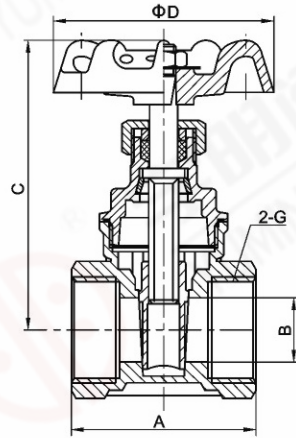
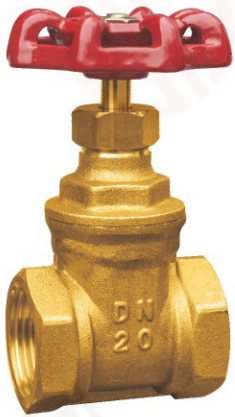

Model: Z15W-16T

DN	Size	A	B	C	D	G
15	1/2	43	12.7	71	54	1/2
20	3/4	46	16	76.5	54	3/4
25	1	49	20	86	60	1
32	1 1/4	52	26	99	68	1 1/4
40	1 1/2	56.5	32	109.5	72	1 1/2
50	2	64	43	130.5	80	2
65	2 1/4	80	52	156.5	100	2 1/4
80	3	83	63.5	183.5	110	3
100	4	101.5	84	223	126	4

### Specifications

Nominal pressure: 1.6MPa

Working TEMP:  $-20^{\circ}\text{C} \leq T \leq 150^{\circ}\text{C}$

Working medium: Water, non-corrosive liquid, saturated steam ( $\leq 0.6\text{MPa}$ )

Cylindrical thread meets ISO 228 standard

## Brass Lock Gate Valve

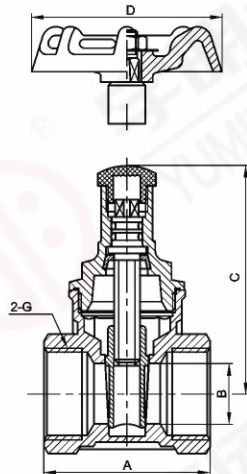

Model: Z15W-16T

DN	Size	A	B	C	D	G
15	1/2	43	12.7	63.1	54	1/2
20	3/4	46	16	67	54	3/4
25	1	49	20	72.7	60	1
32	1 1/4	52	26	82.3	72	1 1/4
40	1 1/2	56.5	32	96.6	80	1 1/2
50	2	64	43	110.3	80	2

### Specifications

Nominal pressure: 1.6MPa

Working TEMP:  $-10^{\circ}\text{C} \leq T \leq 110^{\circ}\text{C}$

Working medium: Water, non-corrosive liquid

Cylindrical thread meets ISO 228 standard

## Brass Magnetic Lock Gate Valve

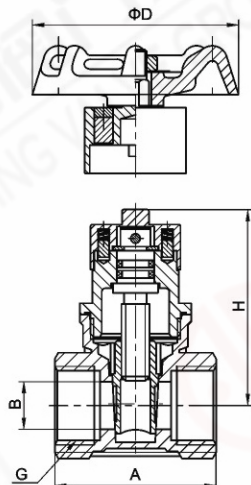

Model: Z15W-16T

DN	A	B	D	H	G
Hand wheel					
15	43	12.7	54	75	1/2
20	46	16	54	82.5	3/4
25	49	20	54	88	1
Long handle lock					
32	52	26	-	76.3	1 1/4
40	56.5	32	-	89.3	1 1/2
50	64	43	-	104.3	2

### Specifications

Nominal pressure: 1.6MPa

Working TEMP:  $-20^{\circ}\text{C} \leq T \leq 120^{\circ}\text{C}$

Working medium: Water, non-corrosive liquid, saturated steam ( $\leq 0.6\text{MPa}$ )

Cylindrical thread meets ISO 228 standard



# Brass Valve Series

### Brass Flange Gate Valve

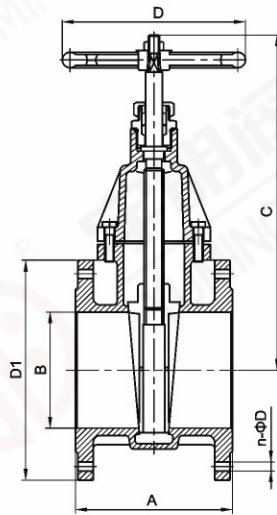

Model: Z45W-16T

DN	A	B	C	D	D1	ΦD	n
125	178	125	381.5	237	245	18	8
150	201	150	433.5	237	280	22	8
200	247.5	200	553.5	320	335	22	8

### Specifications

Nominal pressure: 1.6MPa

Working TEMP:  $-20^{\circ}\text{C} \leq T \leq 150^{\circ}\text{C}$

Working medium: Water, non-corrosive liquid, saturated steam ( $\leq 0.6\text{MPa}$ )

### Brass Check Valve

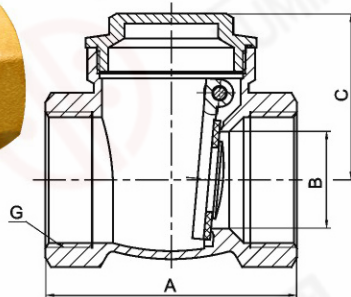

Model: H14X-16T

DN	Size	A	B	C	G
15	1/2	48	13	34	1/2
20	3/4	59	17	40.5	3/4
25	1	68	23	46	1
32	1 1/4	78	30	51.5	1 1/4
40	1 1/2	88	35	57.5	1 1/2
50	2	105	45	68.5	2
65	2 1/2	130	63	85.5	2 1/2
80	3	147	75	95.5	3
100	4	180	93	116.5	4

### Specifications

Nominal pressure: 1.6MPa

Working TEMP:  $T \leq 110^{\circ}\text{C}$

Working medium: Water, non-corrosive liquid

Cylindrical thread meets ISO 228 standard

### Brass Vertical Check Valve

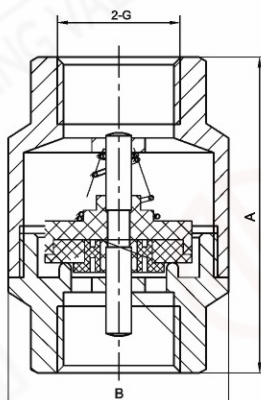

Model: H12X-10T

DN	Size	A	B	G
10	3/8	43	30	3/8
15	1/2	49.5	35	1/2
20	3/4	53.5	41	3/4
25	1	60	49	1
32	1 1/4	70	58	1 1/4
40	1 1/2	77.5	67.5	1 1/2
50	2	84.5	83	2

### Specifications

Nominal pressure: 1.6MPa

Working TEMP:  $-20^{\circ}\text{C} \leq T \leq 80^{\circ}\text{C}$

Working medium: Water, non-corrosive liquid, saturated steam ( $\leq 0.6\text{MPa}$ )

Cylindrical thread meets ISO 228 standard

# Brass Valve Series

## Brass Piston Pressure Reducing valve

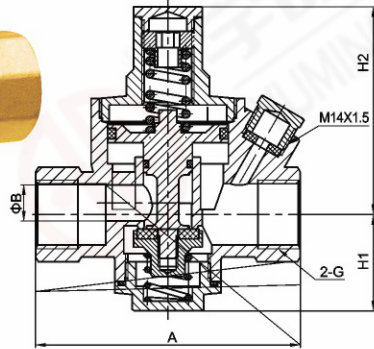

### Model:Y13X-16T

DN	Size	A	B	H1	H2	G
15	1/2	78	11	29.5	64	1/2
20	3/4	78.5	11	30	63.5	3/4
25	1	85	15	35.5	77	1
32	1 1/4	85	18	37	79	1 1/4
40	1 1/2	103	22.5	47.5	105	1 1/2
50	2	120	28.5	54.5	126.5	2

### Specifications

Nominal pressure:1.6MPa

Outlet pressure:0.1MPa~0.55MPa

Working TEMP:0°C≤T≤80°C

Working medium:Water

Cylindrical thread meets ISO 228 standard

## Brass Exhaust Valve

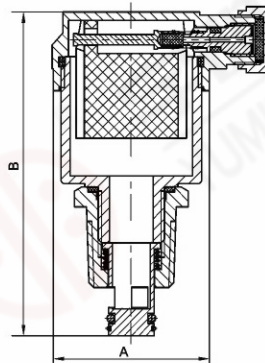

### Model:P25X-16T

DN	A	B
15	38.5	78.5
20	38	77.5
25	38	77.5

### Specifications

Nominal pressure:1.6MPa

Working TEMP:0°C≤T≤120°C

Working medium:Water

Cylindrical thread meets ISO 228 standard

## Brass Automatic Temperature Control Valve

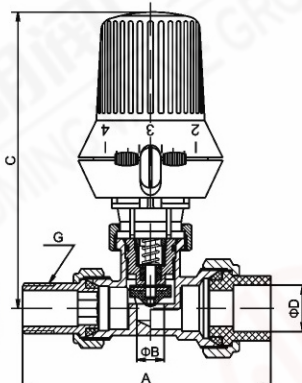

### Model:J61W-16T

DN	A	B	C	D	E	ΦD	n
15	78	12	74	157.5	90	14	4
20	78	15	69	157.5	100	14	4
25	81	20	74	157.5	110	14	4
32	87	25	85.5	167.5	132	18	4
40	102	32	93.7	185.9	143	18	4
50	101	40	105.3	185.9	158	18	4
65	104	50	125.5	215	178	18	8
80	124	65	134.8	218.9	193	18	8
100	136	80	151.8	219	213	18	8

### Specifications

Nominal pressure:1.6MPa

Temperature control range:6°C~28°C

Working TEMP:0°C≤T≤120°C

Working medium:Water,saturated steam(≤0.6MPa)

Cylindrical thread meets ISO 228 standard